

SADEVdecor



www.v3s-glass-systems.be

V3S Glass Systems BVBA
Bossestraat 4
9420 Erpe
Tel.: 053 80 87 77
Fax: 053 80 82 64
E-mail: info@v3s-glass-systems.be

WALL POINT FIXING

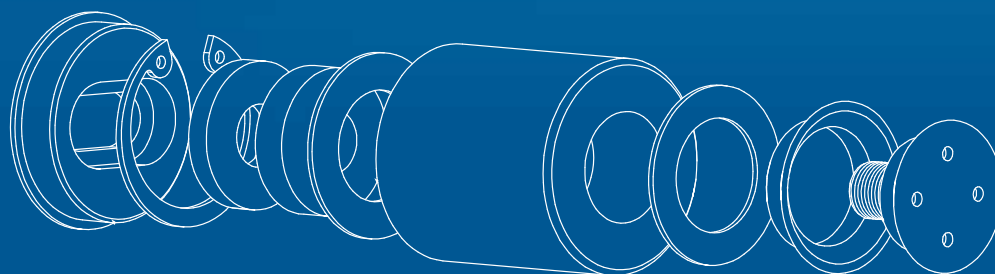

WALL POINT FIXING ::

3.00



www.sadev.com

Tel : + 33 (0)4 50 08 39 00 - info@sadev.com - Fax : + 33 (0)4 50 08 39 49



SUMMARY

WALL POINT
FIXING ::
Pages 3.03 >> 3.19

Adjustable wall mounting point
height 30 mm
Ref: 01 10 01
> Page 3.04



Adjustable wall mounting point
height 40 mm
Ref: 01 10 02
> Page 3.05



Adjustable wall mounting point
height 50 mm
Ref: 01 10 03
> Page 3.06



Fixed wall mounting point
height 20 mm Ø 30
Ref: 01 00 10
> Page 3.08



Fixed wall mounting point
height 3 mm
Ref: 01 00 20
> Page 3.09



Fixed wall mounting point
height 14 mm
Ref: 01 00 30
> Page 3.10



Fixed wall mounting point
height 20 mm
Ref: 01 10 00
> Page 3.11



Fixed wall mounting point
height 30 mm
Ref: 01 10 01 FX
> Page 3.12



Fixed wall mounting point
height 40 mm
Ref: 01 10 02 FX
> Page 3.13



Fixed wall mounting point
height 50 mm
Ref: 01 10 03 FX
> Page 3.14



Fixed wall mounting point
height 60 mm
Ref: 01 10 04 FX
> Page 3.15



Fixed wall mounting point
height 70 mm
Ref: 01 10 05 FX
> Page 3.16



Fixed wall mounting point
height 80 mm
Ref: 01 10 06 FX
> Page 3.17



Fixed wall mounting point
height 100 mm
Ref: 01 10 07 FX
> Page 3.18

Wall points technical page

Adjustable wall point

Adjustment (1):

Adjustment of the wall point by ± 5 mm on the support by slot hole

Adjustment (3):

Height adjustment by 0 to + 3 mm from the support (wall, plasterboard, etc.) in relation to the glass via the body which is adjustable by tightening or loosening

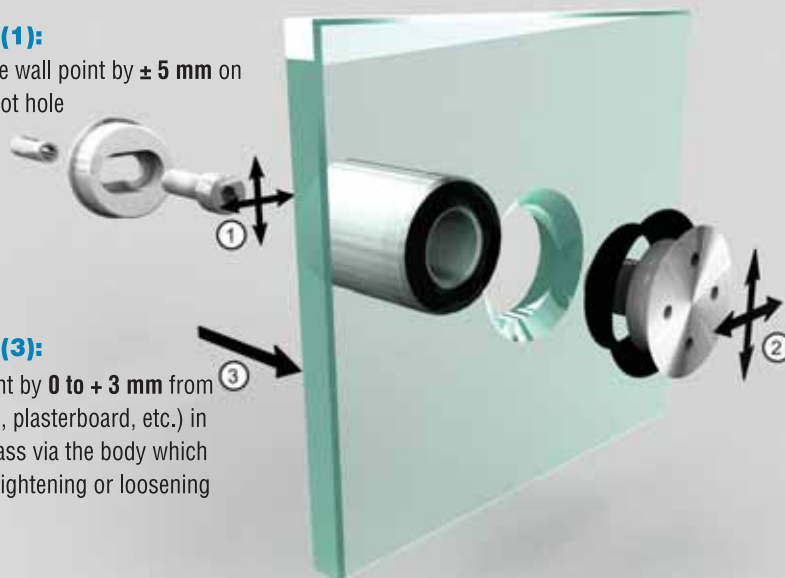
**Adjustment (2):**

Bi-dimensional adjustment of the glass fixing screw by ± 3 mm blind

Screws for glass:

Countersunk or cylindrical possible. See detailed pages of this section



Glass drilling details: see following pages

Arrangement of drilled holes

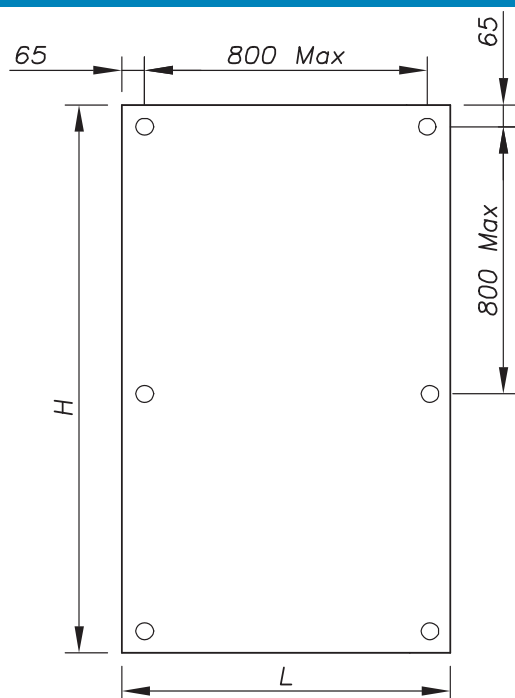

Height of wall points

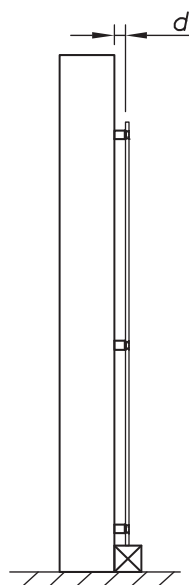

DISTANCE d

Model	d (mm)	Adjustment
01 10 01	30-33	Triple adjustment
01 10 02	40-43	Triple adjustment
01 10 03	50-53	Triple adjustment



The weight of the glass panel is not supported by the fixing points

Glass drilling details: see following pages

Recommendation / use

Glass thickness: 8 to 12 mm standard.
Other dimensions: on request

The glass panel is laid on the ground and is weighed. Other applications: on request

Tightening of the glass screws: Monolithic tempered = Min. 15 N.m / Laminated tempered = 5 N.m

Screws for the wall: top or bottom cylindrical head $\varnothing 8$ hexagonal hollow (D912 or D7984) not supplied by SADEV. Anchor to be defined according to the nature of the wall. Not supplied by SADEV

If components are damaged they can be replaced by request.

Order form end of this chapter.

Model:	01 10 01
Description:	Wall point fixing Height-adjustable 30 mm

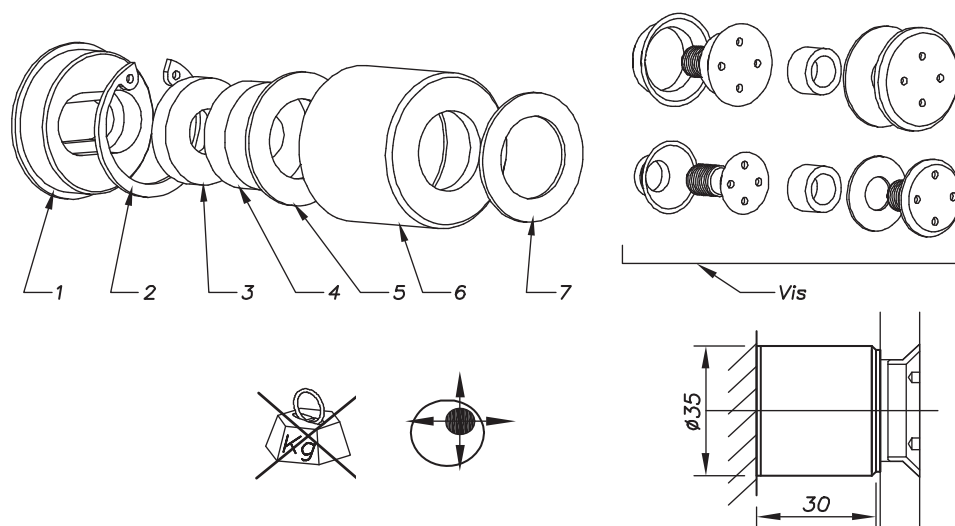
**Description**

- Wall support cap (1)
- Clip (2)
- Special washer 1 (3)
- Tightening nut (4)
- Special washer 2 (5)
- Support body HT 29 (6)
- EPDM washer (7)

It is fitted with a Ø 8 cylindrical head screw in the wall

Weight: 175 g

Photo	Type of screw	Glass thickness	Reference	Glass drilling
		8 to 12	01 10 01 06 11 16	
		Other glass thicknesses on order		
		lead time (cf. page 1)		
		8 to 12	01 10 01 06 12 18	
		Other glass thicknesses on order		
		lead time (cf. page 1)		
		8 to 12	01 10 01 06 24 26	
		Other glass thicknesses on order		
		lead time (cf. page 1)		
		8 to 12	01 10 01 06 23 26	
		Other glass thicknesses on order		
		lead time (cf. page 1)		

Finish: glass bead or brushed

If components are damaged they can be replaced by request.

Order form end of this chapter.

Model:	01 10 02
Description:	Wall point fixing Height-adjustable 40 mm

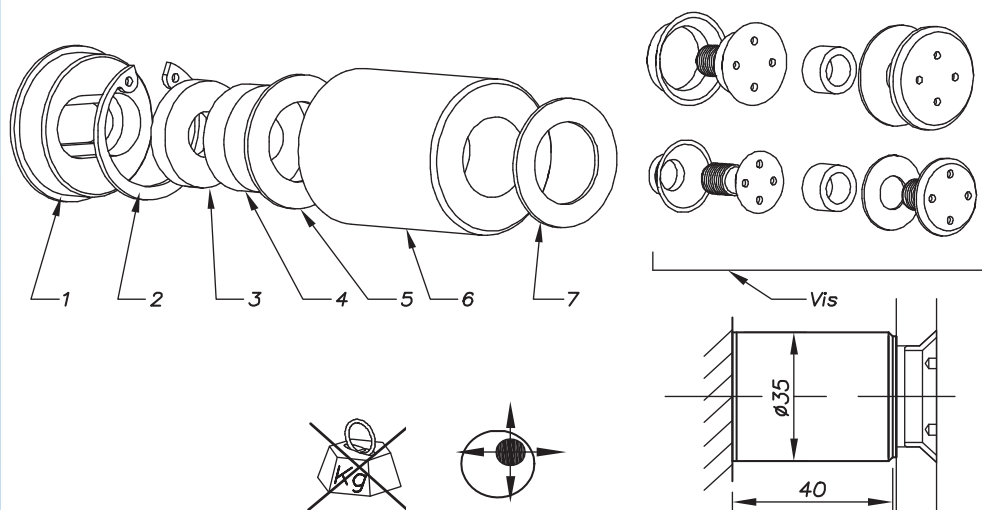
**Description**

- Wall support cap (1)
- Clip (2)
- Special washer 1 (3)
- Tightening nut (4)
- Special washer 2 (5)
- Support body HT 39 (6)
- EPDM washer (7)

It is fitted with a Ø 8 cylindrical head screw in the wall

Weight: 243 g

Photo	Type of screw	Glass thickness	Reference	Glass drilling
		8 to 12	01 10 02 06 11 29	
		Other glass thicknesses on order		
		lead time (cf. page 1)		
		Qty<50	50<Qty<100	100<Qty
		8 to 12	01 10 02 06 12 31	
		Other glass thicknesses on order		
		lead time (cf. page 1)		
		Qty<50	50<Qty<100	100<Qty
		8 to 12	01 10 02 06 24 38	
		Other glass thicknesses on order		
		lead time (cf. page 1)		
		Qty<50	50<Qty<100	100<Qty
		8 to 12	01 10 02 06 23 38	
		Other glass thicknesses on order		
		lead time (cf. page 1)		
		Qty<50	50<Qty<100	100<Qty

Finish: glass bead or brushed

If components are damaged they can be replaced by request.

Order form end of this chapter.

Model:	01 10 03
Description:	Wall point fixing Height-adjustable 50 mm

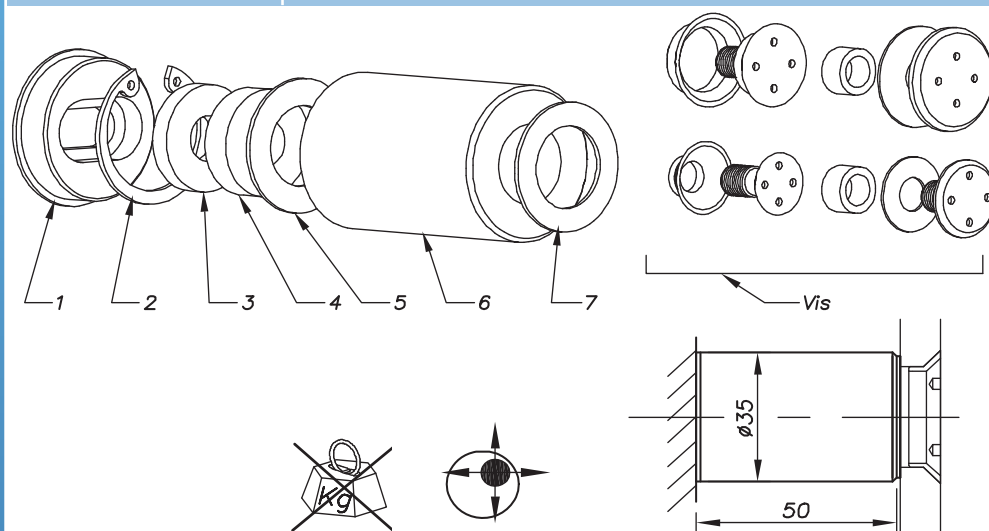
**Description**

- Wall support cap (1)
- Clip (2)
- Special washer 1 (3)
- Tightening nut (4)
- Special washer 2 (5)
- Support body HT 49 (6)
- EPDM washer (7)

It is fitted with a Ø 8 cylindrical head screw in the wall

Weight: 305 g

Photo	Type of screw	Glass thickness	Reference	Glass drilling
		8 to 12	01 10 03 06 11 39	
		Other glass thicknesses on order		
		lead time (cf. page 1)		
		8 to 12	01 10 03 06 12 41	
		Other glass thicknesses on order		
		lead time (cf. page 1)		
		8 to 12	01 10 03 06 24 48	
		Other glass thicknesses on order		
		lead time (cf. page 1)		
		8 to 12	01 10 03 06 23 48	
		Other glass thicknesses on order		
		lead time (cf. page 1)		

Finish: glass bead or brushed

If components are damaged they can be replaced by request.

Order form end of this chapter.

Wall points technical page

Fixed wall point

Adjustment (1):

Adjustment of the wall point by ± 5 mm by slot hole

Adjustment (3):

Height adjustment by 0 to + 3 mm from the support (wall, plasterboard, etc.) in relation to the glass via the body which is adjustable by tightening or loosening

Installation:

To ensure that the wall point and its anchor plug can hold a weight of 50 kg, the slot hole must **ABSOLUTELY** be **HORIZONTAL**

Warning - adjustment:

References **01 00 10** & **01 00 20** have no possibility of adjustment. This implies that the glass drilling tolerance must be absolutely respected ($\pm 0,5$ mm)

Screws for glass:

Countersunk or cylindrical possible. See detailed pages of this section



Glass drilling details – cf. following pages

Arrangement of drilled holes

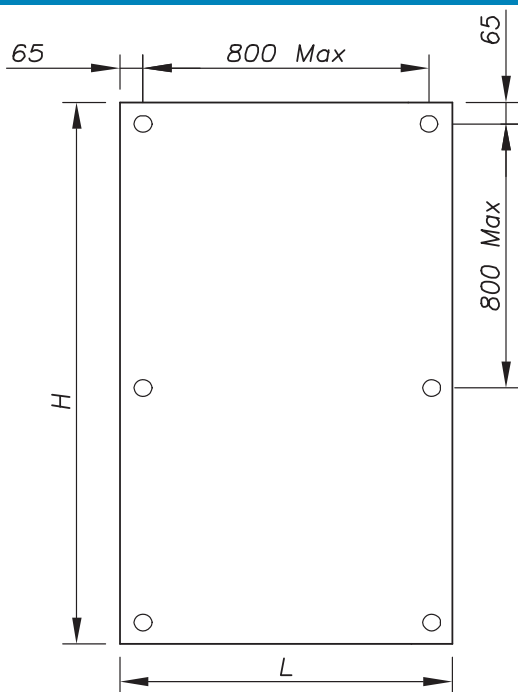

Height of wall points

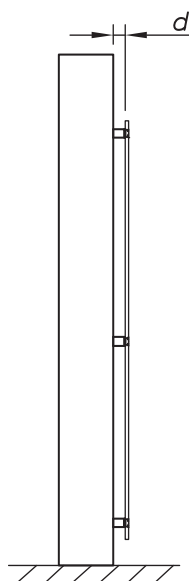

DISTANCE d

Model	d (mm)	Adjustment
01 00 10 *	20	No adjustment
01 00 20 *	3	No adjustment
01 00 30	14-17	Adjustments by slot
01 10 00	20-23	Adjustments by slot
01 10 01 FX	30-33	Adjustments by slot
01 10 02 FX	40-43	Adjustments by slot
01 10 03 FX	50-53	Adjustments by slot
01 10 04 FX	60-63	Adjustments by slot
01 10 05 FX	70-73	Adjustments by slot
01 10 06 FX	80-83	Adjustments by slot
01 10 07 FX	100-103	Adjustments by slot

* Be careful about the quality of glass drilling

Glass drilling details - see following pages

Recommendation / use

Glass thickness: 8 to 12 mm standard. Others: on request

The weight of the glass panel is supported by the fixings. **Be careful about the quality of plugs in the wall and the direction of the oblong hole**

Tightening of the glass screws:

Monolithic tempered = Min. 15 N.m
Laminated tempered = 5 N.m

Screws for the wall: top or bottom cylindrical head $\varnothing 8$ hexagonal hollow (D912 or D7984) not supplied by SADEV. Anchor to be defined according to the nature of the wall. Not supplied by SADEV

If components are damaged they can be replaced by request.
Order form end of this chapter.

Model:	01 00 10
Description:	Wall point fixing Fixed height 20 mm

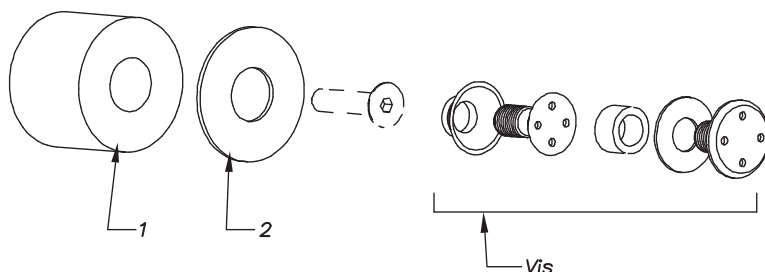
**Description**

Wall support body height 19 Ø 30 (1)
EPDM washer (2)

**No adjustment on this
reference**

**It is fitted with a Ø 5
countersunk head screw in the
wall**



30 kg

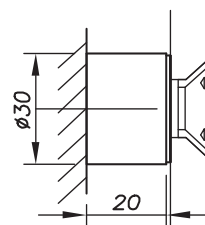

Weight: 122 g

Photo	Type of screw	Glass thickness	Reference	Glass drilling
		8 to 12	01 00 10 06 12 12	
		Other glass thicknesses on order		
		lead time (cf. page 1)		
		Qty<100	100<Qty<200	200<Qty
		8 to 12	01 00 10 06 23 20	
		Other glass thicknesses on order		
		lead time (cf. page 1)		
		Qty<100	100<Qty<200	200<Qty

Finish: glass bead or brushed

If components are damaged they can be replaced by request.

Order form end of this chapter.

Model:	01 00 20
Description:	Wall point fixing Fixed height 3 mm

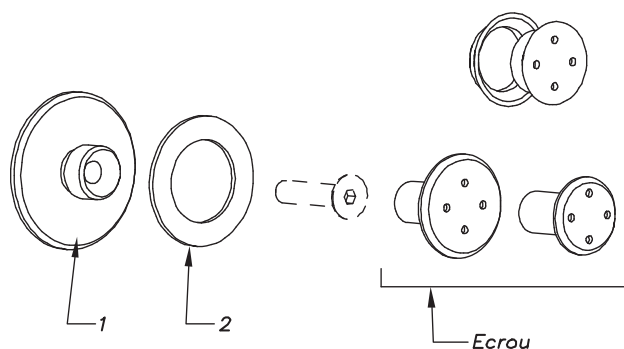
**Description**

Wall support body height 2 (1)
EPDM washer (2)

No adjustment on this reference

It is fitted with a Ø 5 countersunk head screw in the wall

Weight: 50 g



30 kg

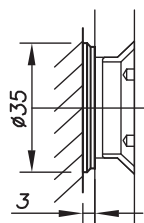

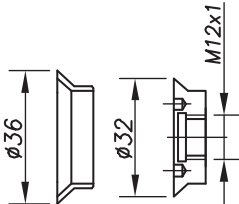
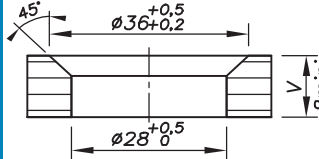
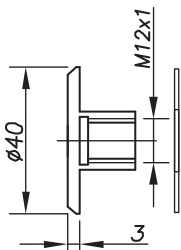
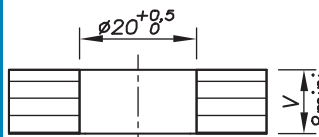
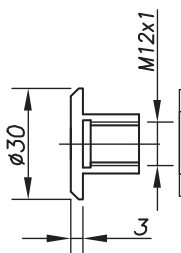
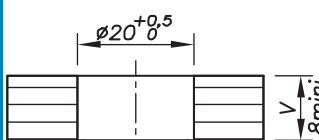

Photo	Type of screw	Glass thickness	Reference	Glass drilling
		8	01 00 20 07 11 08	
		10	01 00 20 07 11 10	
		12	01 00 20 07 11 12	
		Other glass thicknesses on order		
		lead time (cf. page 1)		
	Qty<50		50<Qty<100	100<Qty
		8	01 00 20 07 24 11	
		10	01 00 20 07 24 13	
		12	01 00 20 07 24 15	
		Other glass thicknesses on order		
		lead time (cf. page 1)		
	Qty<50		50<Qty<100	100<Qty
		8	01 00 20 07 23 11	
		10	01 00 20 07 23 13	
		12	01 00 20 07 23 15	
		Other glass thicknesses on order		
		lead time (cf. page 1)		
	Qty<50		50<Qty<100	100<Qty

Finish: glass bead or brushed

Finish: glass bead or brushed

If components are damaged they can be replaced by request.

Order form end of this chapter.

Model:	01 00 30
Description:	Wall point fixing Fixed height 14 mm

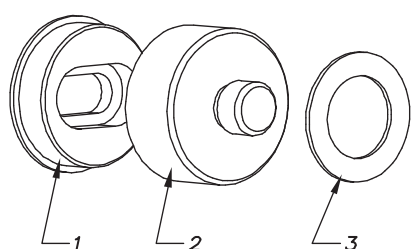
**Description**

- Wall support cap (1)
Wall support body height 13 mm (2)
EPDM washer (3)

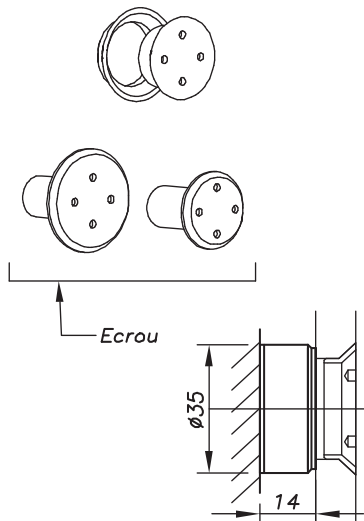
**50 kg**

It is fitted with a Ø 8 cylindrical head screw in the wall

Weight: 112 g

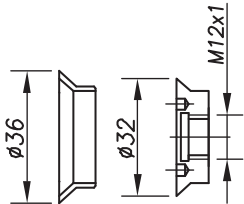
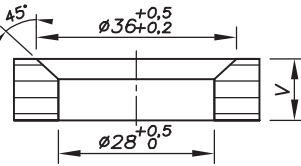
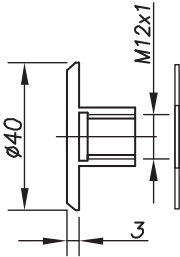
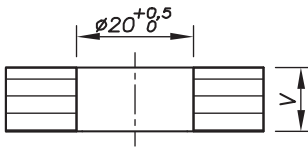
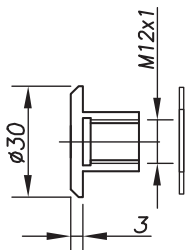
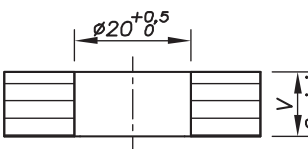
Photo	Type of screw	Glass thickness	Reference	Glass drilling
		8	01 00 30 07 11 08	
		10	01 00 30 07 11 10	
		12	01 00 30 07 11 12	
		Other glass thicknesses on order		
		lead time (cf. page 1)		
	Qty<50		50<Qty<100	100<Qty
		8	01 00 30 07 24 11	
		10	01 00 30 07 24 13	
		12	01 00 30 07 24 15	
		Other glass thicknesses on order		
		lead time (cf. page 1)		
	Qty<50		50<Qty<100	100<Qty
		8	01 00 30 07 23 11	
		10	01 00 30 07 23 13	
		12	01 00 30 07 23 15	
		Other glass thicknesses on order		
lead time (cf. page 1)				
Qty<50		50<Qty<100	100<Qty	

Finish: glass bead or brushed

Finish: glass bead or brushed

If components are damaged they can be replaced by request.

Order form end of this chapter.

Model:	01 10 00
Description:	Wall point fixing Fixed height 20 mm

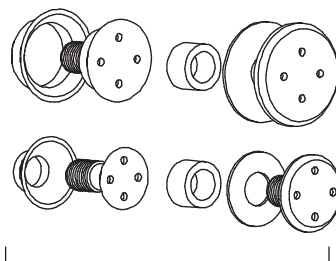
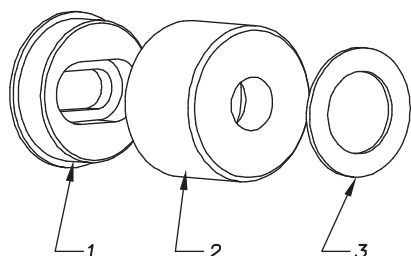

Vis

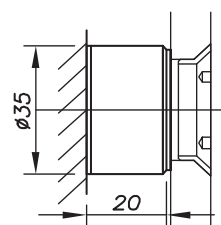

50 kg

**Description**

- Wall support cap (1)
Wall support body height 19 mm (2)
EPDM washer (3)

It is fitted with a Ø 8 cylindrical head screw in the wall

Weight: 157 g

Photo	Type of screw	Glass thickness	Reference	Glass drilling
		8 to 12	01 10 00 06 11 10	
		Other glass thicknesses on order		
		lead time (cf. page 1)		
		Qty<50	50<Qty<100	100<Qty
		8 to 12	01 10 00 06 12 12	
		Other glass thicknesses on order		
		lead time (cf. page 1)		
		Qty<50	50<Qty<100	100<Qty
		8 to 12	01 10 00 06 24 20	
		Other glass thicknesses on order		
		lead time (cf. page 1)		
		Qty<50	50<Qty<100	100<Qty
		8 to 12	01 10 00 06 23 20	
		Other glass thicknesses on order		
		lead time (cf. page 1)		
		Qty<50	50<Qty<150	150<Qty

Finish: glass bead or brushed

If components are damaged they can be replaced by request.

Order form end of this chapter.

Model:	01 10 01 FX
Description:	Wall point fixing Fixed height 30 mm

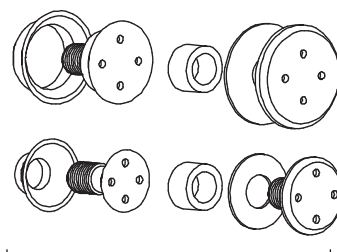
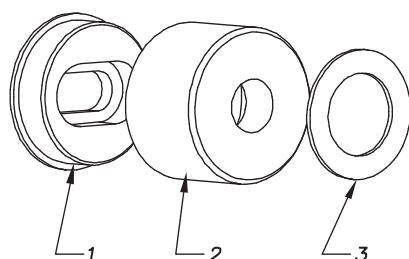
**Description**

- Wall support cap (1)
Wall support body height 29 mm (2)
EPDM washer (3)

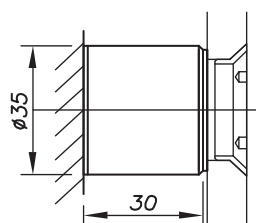
**50 kg**

It is fitted with a Ø 8 cylindrical head screw in the wall

Weight: 214 g

Photo	Type of screw	Glass thickness	Reference	Glass drilling
		8 to 12	01 10 01 FX 06 11 10	
		Other glass thicknesses on order		
		lead time (cf. page 1)		
		Qty<50	50<Qty<100	100<Qty
		8 to 12	01 10 01 FX 06 12 12	
		Other glass thicknesses on order		
		lead time (cf. page 1)		
		Qty<50	50<Qty<100	100<Qty
		8 to 12	01 10 01 FX 06 24 20	
		Other glass thicknesses on order		
		lead time (cf. page 1)		
		Qty<50	50<Qty<100	100<Qty
		8 to 12	01 10 01 FX 06 23 20	
		Other glass thicknesses on order		
		lead time (cf. page 1)		
		Qty<50	50<Qty<100	100<Qty

Finish: glass bead or brushed

If components are damaged they can be replaced by request.

Order form end of this chapter.

Model:	01 10 02 FX
Description:	Wall point fixing Fixed height 40 mm

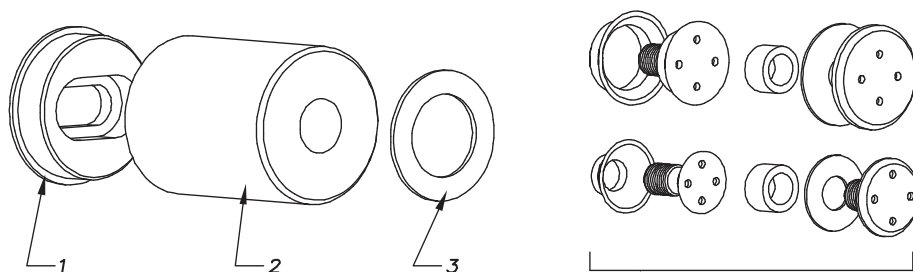
**Description**

- Wall support cap (1)
Wall support body height 39 mm (2)
EPDM washer (3)

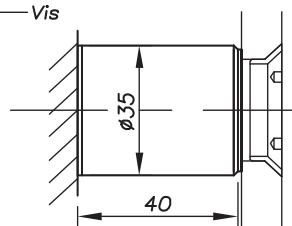
**50 kg**

It is fitted with a Ø 8 cylindrical head screw in the wall

Weight: 296 g

Photo	Type of screw	Glass thickness	Reference	Glass drilling
		8 to 12	01 10 02 FX 06 11 10	
		Other glass thicknesses on order		
		lead time (cf. page 1)		
		Qty<50	50<Qty<100	100<Qty
		8 to 12	01 10 02 FX 06 12 12	
		Other glass thicknesses on order		
		8 to 12	01 10 02 FX 06 24 20	
		Other glass thicknesses on order		
		lead time (cf. page 1)		
		Qty<50	50<Qty<100	100<Qty
		8 to 12	01 10 02 FX 06 23 20	
		Other glass thicknesses on order		
		lead time (cf. page 1)		
		Qty<50	50<Qty<100	100<Qty
		8 to 12	01 10 02 FX 06 23 20	
		Other glass thicknesses on order		
		lead time (cf. page 1)		

Finish: glass bead or brushed

If components are damaged they can be replaced by request.

Order form end of this chapter.

Model:	01 10 03 FX
Description:	Wall point fixing Fixed height 50 mm

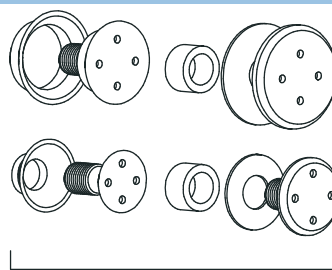
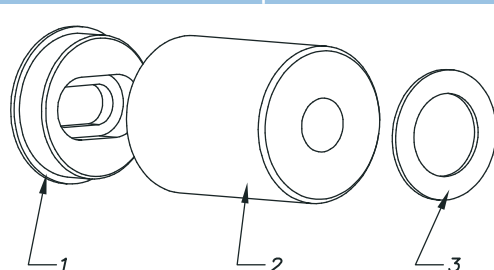
**Description**

- Wall support cap (1)
Wall support body height 49 mm (2)
EPDM washer (3)

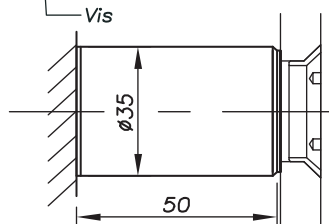
**50 kg**

It is fitted with a Ø 8 cylindrical head screw in the wall

Weight: 375 g

Photo	Type of screw	Glass thickness	Reference	Glass drilling
		8 to 12	01 10 03 FX 06 11 10	
		Other glass thicknesses on order		
		lead time (cf. page 1)		
		8 to 12	01 10 03 FX 06 12 12	
		Other glass thicknesses on order		
		lead time (cf. page 1)		
		8 to 12	01 10 03 FX 06 24 20	
		Other glass thicknesses on order		
		lead time (cf. page 1)		
		8 to 12	01 10 03 FX 06 23 20	
		Other glass thicknesses on order		
		lead time (cf. page 1)		

Finish: glass bead or brushed

If components are damaged they can be replaced by request.

Order form end of this chapter.

Model:	01 10 04 FX
Description:	Wall point fixing Fixed height 60 mm

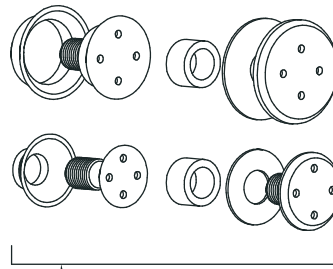
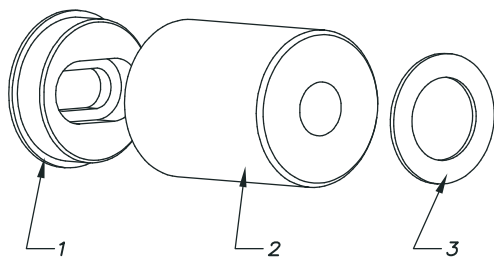
**Description**

- Wall support cap (1)
Wall support body height 59 mm (2)
EPDM washer (3)

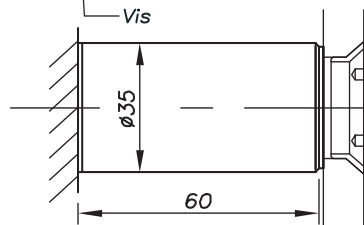
**50 kg**

It is fitted with a $\varnothing 8$ cylindrical head screw in the wall

Weight: 450 g

Photo	Type of screw	Glass thickness	Reference	Glass drilling
		8 to 12	01 10 04 FX 06 11 10	
		Other glass thicknesses on order		
		lead time (cf. page 1)		
		8 to 12	01 10 04 FX 06 12 12	
		Other glass thicknesses on order		
		lead time (cf. page 1)		
		8 to 12	01 10 04 FX 06 24 20	
		Other glass thicknesses on order		
		lead time (cf. page 1)		
		8 to 12	01 10 04 FX 06 23 20	
		Other glass thicknesses on order		
		lead time (cf. page 1)		

Finish: glass bead or brushed

If components are damaged they can be replaced by request.

Order form end of this chapter.

Model:	01 10 05 FX
Description:	Wall point fixing Fixed height 70 mm

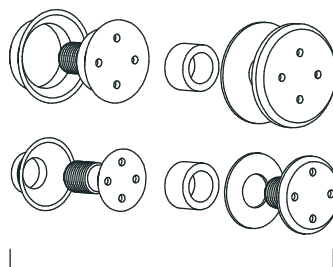
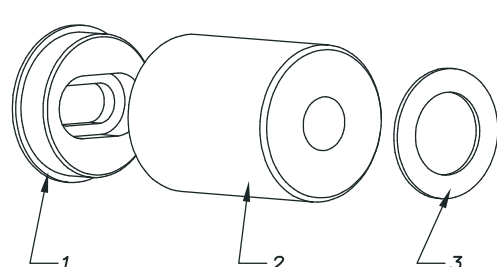
**Description**

- Wall support cap (1)
Wall support body height 69 mm (2)
EPDM washer (3)

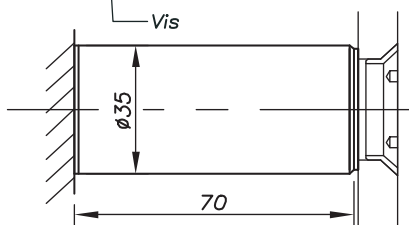
**50 kg**

It is fitted with a Ø 8 cylindrical head screw in the wall

Weight: 522 g

Photo	Type of screw	Glass thickness	Reference	Glass drilling
		8 to 12	01 10 05 FX 06 11 10	
		Other glass thicknesses on order		
		lead time (cf. page 1)		
		Qty<50	50<Qty<150	150<Qty
		8 to 12	01 10 05 FX 06 12 12	
		Other glass thicknesses on order		
		lead time (cf. page 1)		
		Qty<50	50<Qty<200	150<Qty
		8 to 12	01 10 05 FX 06 24 20	
		Other glass thicknesses on order		
		lead time (cf. page 1)		
		Qty<50	50<Qty<150	150<Qty
		8 to 12	01 10 05 FX 06 23 20	
		Other glass thicknesses on order		
		lead time (cf. page 1)		
		Qty<50	50<Qty<150	150<Qty

Finish: glass bead or brushed

If components are damaged they can be replaced by request.

Order form end of this chapter.

Model:	01 10 06 FX
Description:	Wall point fixing Fixed height 80 mm

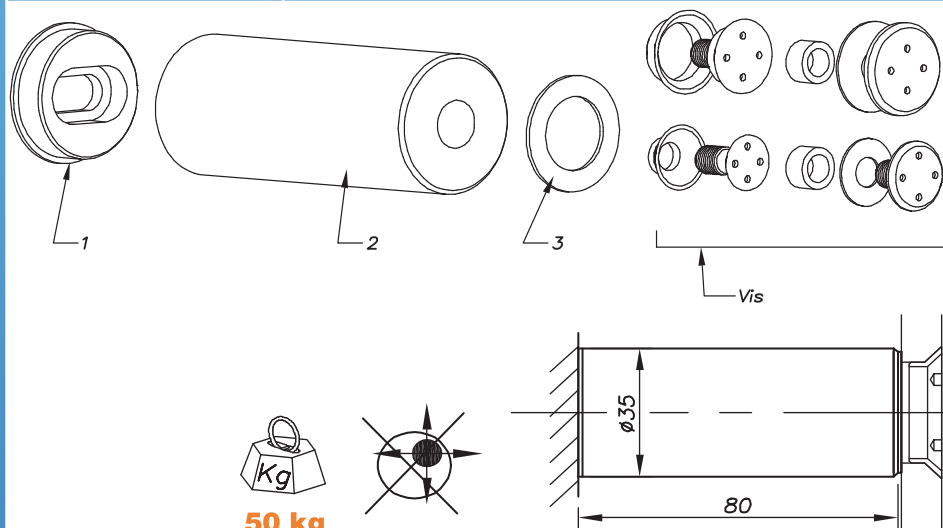

Description

- Wall support cap (1)
- Wall support body height 79 mm (2)
- EPDM washer (3)

It is fitted with a Ø 8 cylindrical head screw in the wall

Weight: 598 g

Photo	Type of screw	Glass thickness	Reference	Glass drilling
		8 to 12	01 10 06 FX 06 11 10	
		Other glass thicknesses on order		
		lead time (cf. page 1)		
		8 to 12	01 10 06 FX 06 12 12	
		Other glass thicknesses on order		
		lead time (cf. page 1)		
		8 to 12	01 10 06 FX 06 24 20	
		Other glass thicknesses on order		
		lead time (cf. page 1)		
		8 to 12	01 10 06 FX 06 23 20	
		Other glass thicknesses on order		
		lead time (cf. page 1)		

Finish: glass bead or brushed

If components are damaged they can be replaced by request.

Order form end of this chapter.

Model:	01 10 07 FX
Description:	Wall point fixing Fixed height 100 mm

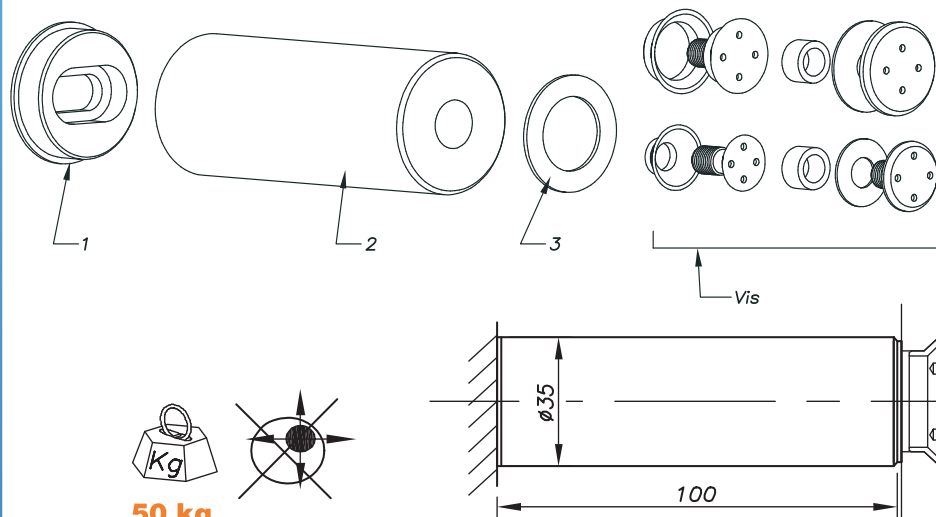
**Description**

- Wall support cap (1)
Wall support body height 99 mm (2)
EPDM washer (3)

It is fitted with a $\varnothing 8$ cylindrical head screw in the wall

Weight: 745 g

Photo	Type of screw	Glass thickness	Reference	Glass drilling
		8 to 12	01 10 07 FX 06 11 10	
		Other glass thicknesses on order		
		lead time (cf. page 1)		
		Qty<50	50<Qty<150	150<Qty
		8 to 12	01 10 07 FX 06 12 12	
		Other glass thicknesses on order		
		lead time (cf. page 1)		
		Qty<50	50<Qty<200	150<Qty
		8 to 12	01 10 07 FX 06 24 20	
		Other glass thicknesses on order		
		lead time (cf. page 1)		
		Qty<50	50<Qty<150	150<Qty
		8 to 12	01 10 07 FX 06 23 20	
		Other glass thicknesses on order		
		lead time (cf. page 1)		
		Qty<50	50<Qty<150	150<Qty

Finish: glass bead or brushed

If components are damaged they can be replaced by request.

Order form end of this chapter.

Price request

Order

Wall points order form

Customer name:

Interlocutor:

Date:

Project
name:

Your phone number:

DISCOUNT

Your fax:

Reference	Finish	Qty	Price
Ht 30 mm AJ	01 10 01 06 11 16	Brushed – Glass bead*	
	01 10 01 06 12 18	Brushed – Glass bead*	
	01 10 01 06 24 26	Brushed – Glass bead*	
	01 10 01 06 23 26	Brushed – Glass bead*	
Ht 40 mm AJ	01 10 02 06 11 29	Brushed – Glass bead*	
	01 10 02 06 12 31	Brushed – Glass bead*	
	01 10 02 06 24 38	Brushed – Glass bead*	
	01 10 02 06 23 38	Brushed – Glass bead*	
Ht 50 mm AJ	01 10 03 06 11 39	Brushed – Glass bead*	
	01 10 03 06 12 41	Brushed – Glass bead*	
	01 10 03 06 24 48	Brushed – Glass bead*	
	01 10 03 06 23 48	Brushed – Glass bead*	
Ht 20 mm	01 00 10 06 12 12	Brushed – Glass bead*	
	01 00 10 06 23 20	Brushed – Glass bead*	
Ht 3 mm FX	01 00 20 07 11 08	Brushed – Glass bead*	
	01 00 20 07 11 10	Brushed – Glass bead*	
	01 00 20 07 11 12	Brushed – Glass bead*	
	01 00 20 07 24 11	Brushed – Glass bead*	
	01 00 20 07 24 13	Brushed – Glass bead*	
	01 00 20 07 24 15	Brushed – Glass bead*	
	01 00 20 07 23 11	Brushed – Glass bead*	
	01 00 20 07 23 13	Brushed – Glass bead*	
	01 00 20 07 23 15	Brushed – Glass bead*	
Ht 14 mm FX	01 00 30 07 11 08	Brushed – Glass bead*	
	01 00 30 07 11 10	Brushed – Glass bead*	
	01 00 30 07 11 12	Brushed – Glass bead*	
	01 00 30 07 24 11	Brushed – Glass bead*	
	01 00 30 07 24 13	Brushed – Glass bead*	
	01 00 30 07 24 15	Brushed – Glass bead*	
	01 00 30 07 23 11	Brushed – Glass bead*	
	01 00 30 07 23 13	Brushed – Glass bead*	
	01 00 30 07 23 15	Brushed – Glass bead*	
AJ = adjustable		FX = fixed	

Reference	Finish	Qty	Price
Ht 20 mm FX	01 10 00 06 11 10	Brushed – Glass bead*	
	01 10 00 06 12 12	Brushed – Glass bead*	
	01 10 00 06 24 20	Brushed – Glass bead*	
	01 10 00 06 23 20	Brushed – Glass bead*	
Ht 30 mm FX	01 10 01 FX 06 11 10	Brushed – Glass bead*	
	01 10 01 FX 06 12 12	Brushed – Glass bead*	
	01 10 01 FX 06 24 18	Brushed – Glass bead*	
	01 10 01 FX 06 23 18	Brushed – Glass bead*	
Ht 40 mm FX	01 10 02 FX 06 11 10	Brushed – Glass bead*	
	01 10 02 FX 06 12 12	Brushed – Glass bead*	
	01 10 02 FX 06 24 20	Brushed – Glass bead*	
	01 10 02 FX 06 23 20	Brushed – Glass bead*	
Ht 50 mm FX	01 10 03 FX 06 11 10	Brushed – Glass bead*	
	01 10 03 FX 06 12 12	Brushed – Glass bead*	
	01 10 03 FX 06 24 20	Brushed – Glass bead*	
	01 10 03 FX 06 23 20	Brushed – Glass bead*	
Ht 60 mm FX	01 10 04 FX 06 11 10	Brushed – Glass bead*	
	01 10 04 FX 06 12 12	Brushed – Glass bead*	
	01 10 04 FX 06 24 20	Brushed – Glass bead*	
	01 10 04 FX 06 23 20	Brushed – Glass bead*	
Ht 70 mm FX	01 10 05 FX 06 11 10	Brushed – Glass bead*	
	01 10 05 FX 06 12 12	Brushed – Glass bead*	
	01 10 05 FX 06 24 20	Brushed – Glass bead*	
	01 10 05 FX 06 23 20	Brushed – Glass bead*	
Ht 80 mm FX	01 10 06 FX 06 11 10	Brushed – Glass bead*	
	01 10 06 FX 06 12 12	Brushed – Glass bead*	
	01 10 06 FX 06 24 20	Brushed – Glass bead*	
	01 10 06 FX 06 23 20	Brushed – Glass bead*	
Ht 100 mm FX	01 10 07 FX 06 11 10	Brushed – Glass bead*	
	01 10 07 FX 06 12 12	Brushed – Glass bead*	
	01 10 07 FX 06 24 20	Brushed – Glass bead*	
	01 10 07 FX 06 23 20	Brushed – Glass bead*	
* Delete as inappropriate			