

www.v3s-glass-systems.be



Pentures, serrures
et pièces de fixation
Locks and patch fittings

ASSA ABLOY



Pentures,
serrures et
pièces de fixation
*Locks and
patch fittings*

Cilindric®



Caractéristiques techniques

- Dimensions ø 55 mm hauteur 75 mm
- Inox AISI 304
- Pour verre de 8, 10 et 12 mm
- Montage sur encoche
- Poids maximum 100 kg

Technical features

- Dimensions ø 55 mm height 75 mm
- Stainless steel 304
- For 8, 10 and 12 mm thick glass
- Assembly on notch
- Maximum door weight 100 kg

LES + PRODUITS

The + product

Design High Tech

Grande qualité de finition

Résistance

Modularité

Inox massif

High tech design

High quality finishes

Resistance

Modularity

Solid stainless Steel

C500D

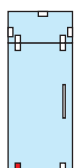
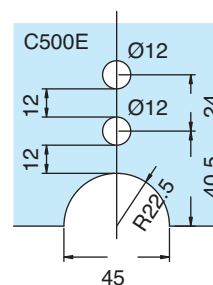
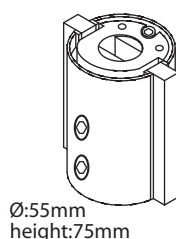

Références / References



Penture basse empreinte pour axe allemand
Bottom patch fitting German insert



C500D.15

C500I

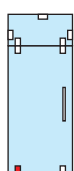
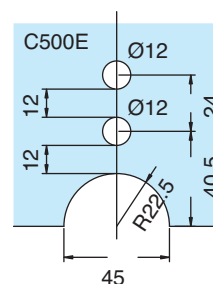
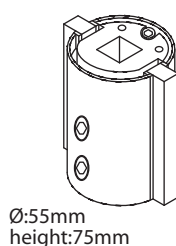

Références / References



Penture basse empreinte pour insert italien
Bottom patch fitting Italian insert



C500I.15



C501

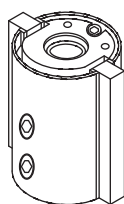

Ø:55mm
height:75mm

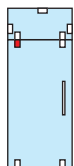
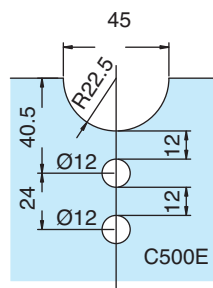

Références / References



Penture haute
Top patch fitting



Inox Brossé
Brushed stainless steel

C501.15

C502

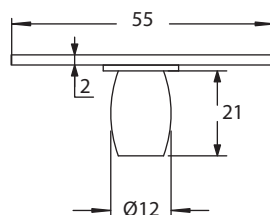

Références / References

Pivot haut, fixation linteau ou plafond
Top pivot, fixing lintel or ceiling



Inox Brossé
Brushed stainless steel

C502.15

C511

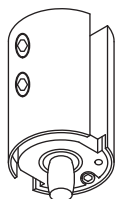

Ø:55mm
height:75mm

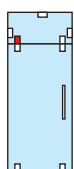
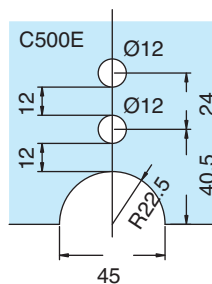

Références / References



Contre-sabot d'imposte avec pivot
Transom panel patch with pivot



Inox Brossé
Brushed stainless steel

C511.15

Pentures,
serrures et
pièces de fixation
*Locks and
patch fittings*



Pentures,
serrures et
pièces de fixation
*Locks and
patch fittings*



AC299.33

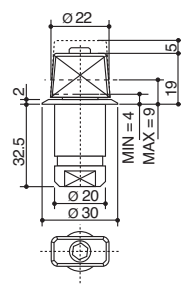

Crapaudine à sceller réglable axe rectangulaire allemand
Adjustable German rectangular floor pivot, to be embedded

AC246.33

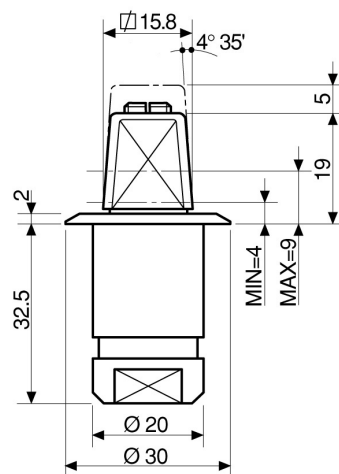

Crapaudine à sceller réglable axe carré italien
Adjustable Italian square floor pivot, to be embedded

V502

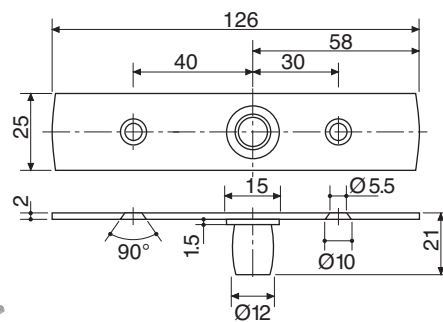

Références / References

Pivot supérieur pour V501/V201
Offset top pivot for V501/V201

Inox Brossé
Stainless steel effect

V502.15

C528A

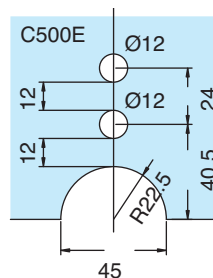
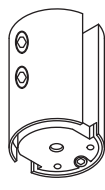

Références / References



Ø:55mm
height:75mm

C528A.15

Pièce de fixation pour panneaux fixe
Wall to glass patch for transom or fixed panel

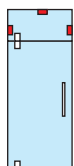

Pentures,
serrures et
pièces de fixation
Locks and
patch fittings

C528B

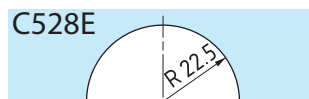
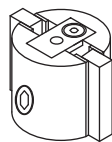

Références / References



Ø:55mm
height:35mm

C528B.15

Cilindric pièce de fixation pour panneaux fixe hauteur 35 mm
Cilindric wall to glass patch for transom or fixed panel height 35mm

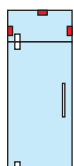

C581

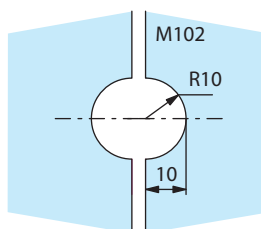
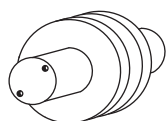

Références / References



C581.15

Pièce de liaison pour 2 glaces fixes modèle rond / simple
Connector for 2 fixed panels single rounded model

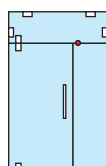

C582

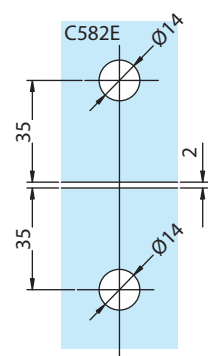
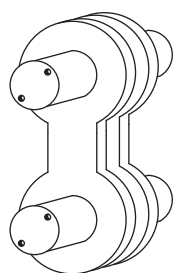

Références / References



C582.15

Pièce de liaison pour 2 glaces fixes modèle '8'
Connector for 2 fixed panels '8' shape

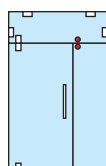

C583

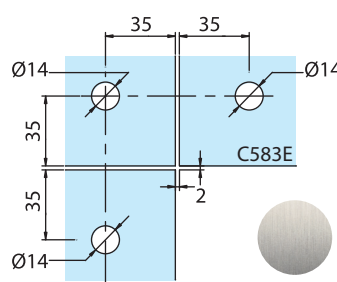
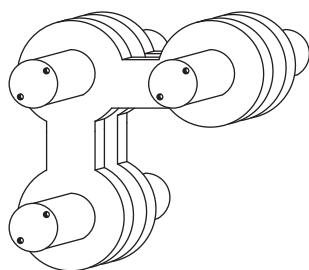

Références / References



C583.15

Pièce de liaison pour 3 glaces fixes
Connector for 3 fixed panels

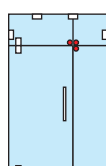

Pentures,
serrures et
pièces de fixation
*Locks and
patch fittings*



C222L

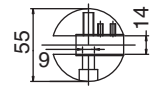
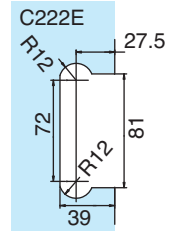
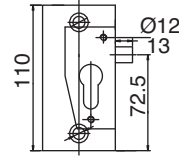
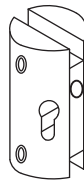

Inox Brossé
Brushed stainless steel

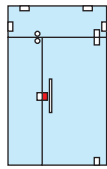

Références / References



Serrure bord de verre gauche extérieur, sans cylindre et sans gâche
Lock on left outside edge of glass, supplied without cylinder and flat keep

C222L.15

C222R

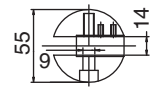
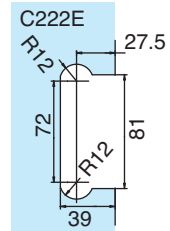
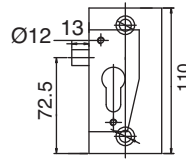
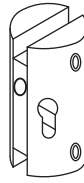

Inox Brossé
Brushed stainless steel

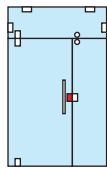

Références / References



Serrure bord de verre droite extérieur, sans cylindre et sans gâche
Lock on right outside edge of glass, supplied without cylinder and flat keep

C222R.15

C223L

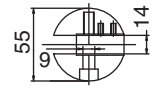
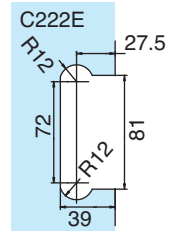
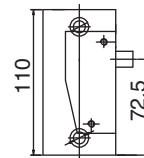
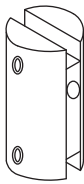

Inox Brossé
Brushed stainless steel

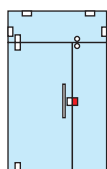

Références / References



Contre-boîtier pour serrure, bord de verre gauche extérieur
Patch keep on left side edge of fixed panel

C223L.15

C223R

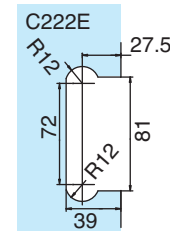
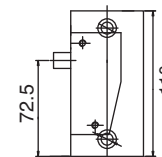
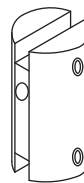

Inox Brossé
Brushed stainless steel

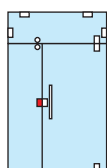

Références / References



Contre-boîtier pour serrure, bord de verre droit extérieur
Patch keep on right side edge of fixed panel

C223R.15



C517

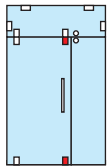
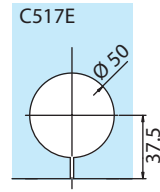
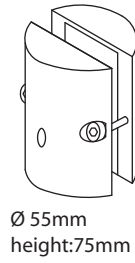

Références / References



Serrure à clé sans gâche
Lock with key without flat keep



Inox Brossé
Brushed stainless steel

C517.15

C529

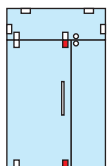
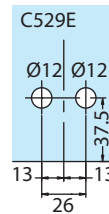
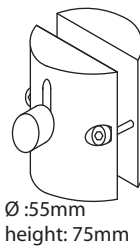

Références / References



Serrure à pieds sans gâche
Foot operated lock without flat keep



Inox Brossé
Brushed stainless steel

C529.15

Pentures,
serrures et
pièces de fixation
*Locks and
patch fittings*



Poignées
Handles



LES + PRODUITS
The + product

Esthétique

Double fonction :
tirage et verrouillage

Robustesse

Porte grande
hauteur

Attractive design

Double function :
pull and lock

Resistant

For high doors

C600PG22

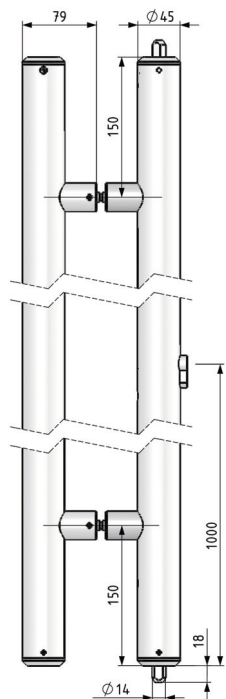

C600PG30

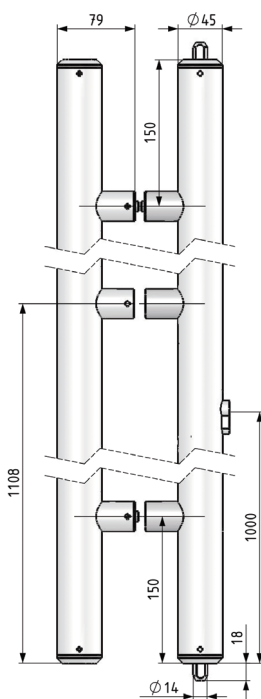

C601PG22

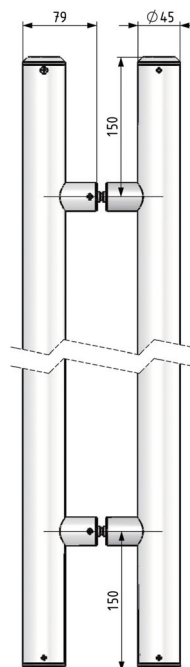

C601PG30

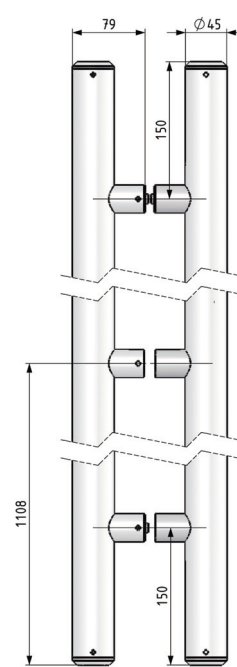

Références / References



Poignées Ø 45 mm, avec serrure 2 points d'un côté, hauteur maxi : 2200 mm
Handle 45 Ø mm with 2 point lock on one side, height max : 2200 mm

C600PG22.15

Poignées Ø 45 mm, avec serrure 2 points d'un côté, hauteur entre 2200 mm et 3000 mm maxi
Handle 45 Ø mm with 2 point lock on one side, height max between 2200 mm and 3000 mm

C600PG30.15

Poignées Ø 45 mm, hauteur maxi : 2200 mm
Handle 45 Ø mm height max 2200 mm

C601PG22.15

Poignées Ø 45 mm, hauteur entre 2200 mm et 3000 mm maxi
Handle 45 Ø mm, height max between 2200 mm and 3000 mm

C601PG30.15



Inox Brossé
Brushed stainless steel





C532



Références / References

Gâche pour poignée C600
Keep plate for C600



Inox Brossé
Brushed stainless steel

C532.15

C541

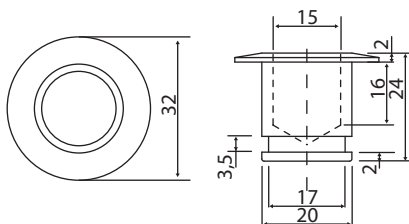

Références / References

Gâche tubulaire pour pêne bas des C600-C517-C529
Tubular keep bottom bolt for C600-C517-C529



Inox Brossé
Brushed stainless steel

C541.15

C603PG

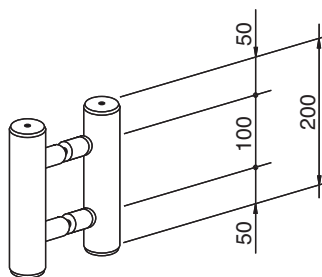

Références / References



Contre-boîtier d'imposte pour C600
Transom patch keep for C600



Inox Brossé
Brushed stainless steel

C603PG.15

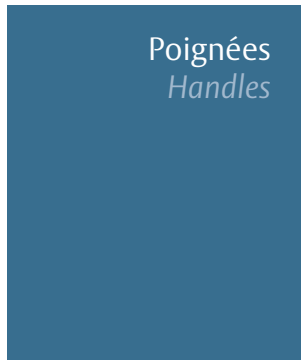

Pentures,
serrures et
pièces de fixation
*Locks and
patch fittings*

Pentures 101

Caractéristiques techniques

- Pour verre trempé de 10 mm
- Montage sur encoche 101
- Poids de porte maximum 50 kg
- Dimensions maxi des portes 900 x 2200 mm
- Réversible droite, gauche, haute ou basse pour les séries 3271 et 3275
- Réversible droite, gauche pour les séries 3272 et 3273
- Livré avec joints épaisseur 1 mm
- Pentures basses compatible avec :
 - Pivot frein de sol hydraulique
 - Crapaudine

Technical features

- For 10 mm thick toughened glass
- Assembly on notch 101
- Maximum door weight 50 kg
- Dimensions size of the doors 900 x 2200 mm
- Top or bottom hinge reversible left or right for series 3271 and 3275
- Left or right hinge reversible for series 3271 and 3275
- Supplied with spacers of 1 mm thick
- Bottom hinge compatible with :
 - Hydraulic floor sprin
 - Pivot



LES + PRODUITS

The + product

Réversible
droite, gauche,
haute ou basse
pour 3271 / 3275

*Top or bottom hinge
reversible left or right
for 3271 and 3275*

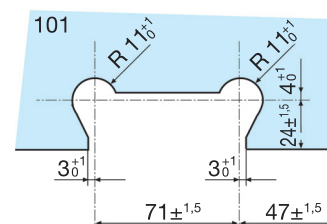
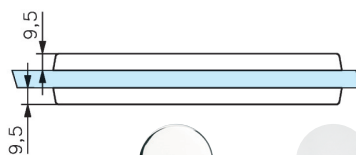
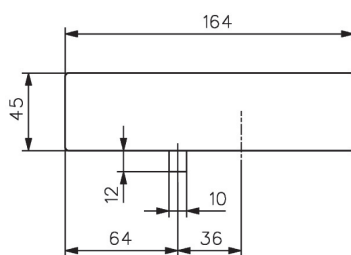

Références / References



3271

Chromé brillant
Bright chromium

Chromé mat
Matt chromium

Doré
Gold plated

Laqué blanc 9010
Lacquered white RAL 9010

Penture réversible haute, basse à enjoliveurs pour axe carré français
Top and bottom reversible patch hinge with cover plate, French square recess

3271.30.0

3271.31.0

3271.40.0

3271.51.0

3272

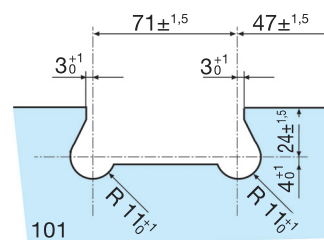
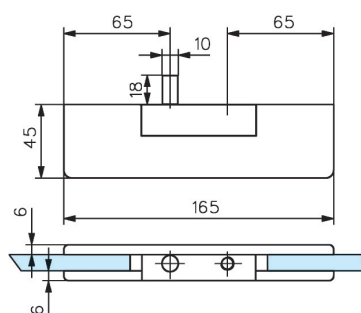
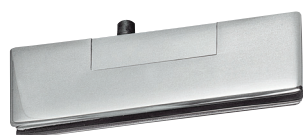

Références / References

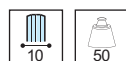

Laiton poli
Polished brass

Chromé brillant
Bright chromium

Chromé mat
Matt chromium

Penture massive haute
Solid top patch hinge

3272.00.0

3272.30.0

3272.31.0



3273

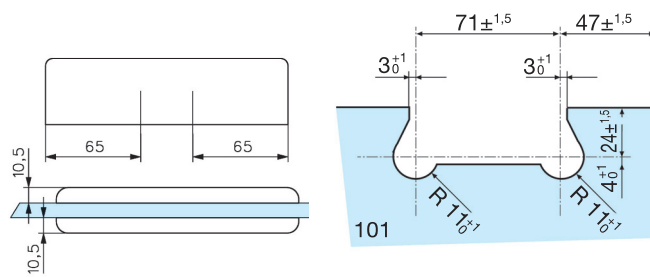

Références / References



Laiton poli
Polished brass



Chromé brillant
Bright chromium



Chromé mat
Matt chromium

Penture massive basse pour axe carré français
Solid bottom patch hinge with French square recess

3273.00.0

3273.30.0

3273.31.0

Pentures,
serrures et
pièces de fixation
Locks and
patch fittings

3280

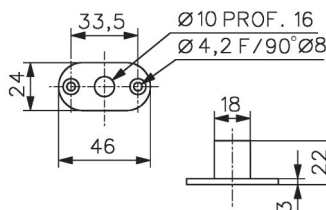

Laiton poli
Polished brass



Chromé brillant
Bright chromium



Chromé mat
Matt chromium

Références / References

Boîte à roulement pour pentures séries 3271, 3272
Bearing box for patch hinges series 3271, 3272

3280.00.0

3280.30.0

3280.31.0

3281

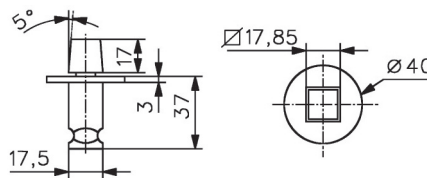

Références / References



Laiton poli
Polished brass



Chromé brillant
Bright chromium



Chromé mat
Matt chromium

Crapaudine à axe carré pour pentures séries 3271 et 3273
Square pin step bearing for patch hinges series 3271 and 3273

3281.00.0

3281.30.0

3281.31.0



Pentures,
serrures et
pièces de fixation
*Locks and
patch fittings*

Serrures basses , boîtier gâche et gâche séries 1358

*Bottom lock, matching patch keep
and keep with guard series 1358*



Caractéristiques techniques

- Pour verre trempé de 10 mm
- Montage sur encoche 61
- Pêne monobloc avec bague anti-sciage
- A cylindre profil européen panneton DIN (norme DIN 18254)
- Livré avec 1 gâche plate et 3 clés

Technical features

- For 10 mm thick toughened glass
- Assembly on notch 61
- One piece bolt with hardened insert
- European profile cylinder (DIN 18254)
- Supplied with flat keep and 3 keys

1358

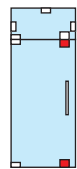
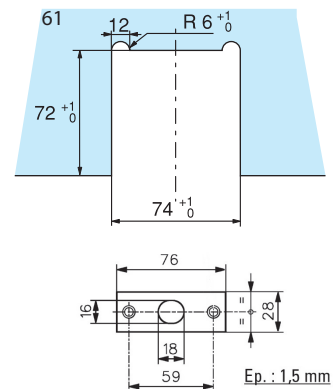
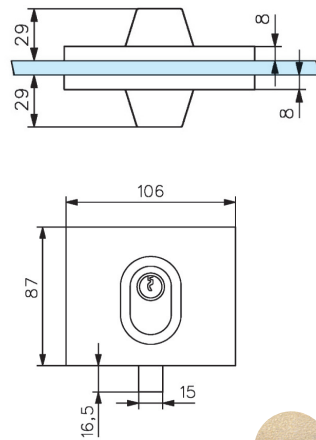

Références / References



Serrure basse avec cylindre à 2 entrées de clé
Bottom lock with euro profile cylinder with 2 key entries

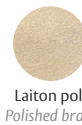

Laiton poli
Polished brass



Chromé brillant
Bright chromium



Chromé mat
Matt chromium

1358.00.0

1358.30.0

1358.31.0

1352

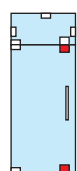
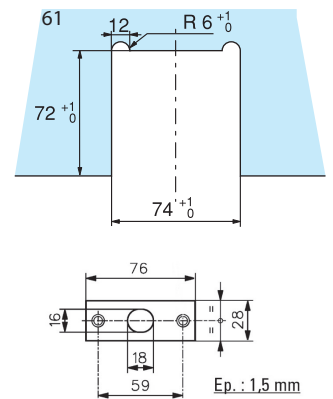
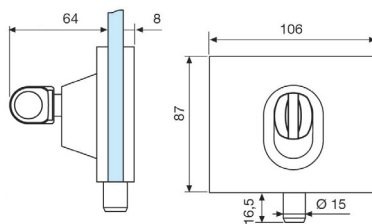

Références / References



Serrure basse à bouton d'un seul côté
Bottom lock with knob on one side



Chromé brillant
Bright chromium



Chromé mat
Matt chromium

1352.30.0

1352.31.0

Pentures, serrures et pièces de fixation
Locks and patch fittings

1353

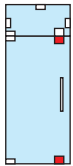
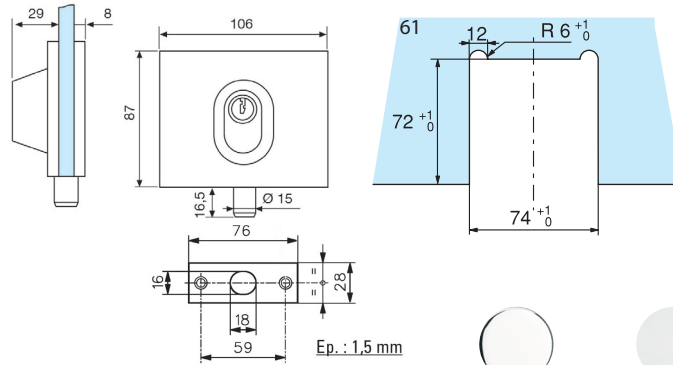

Références / References



Serrure basse à une entrée de clé
Bottom lock with key on one side



Chromé brillant
Bright chromium



Chromé mat
Matt chromium

1353.30.0

1353.31.0

Ep.: 1,5 mm

1359

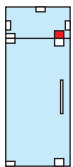
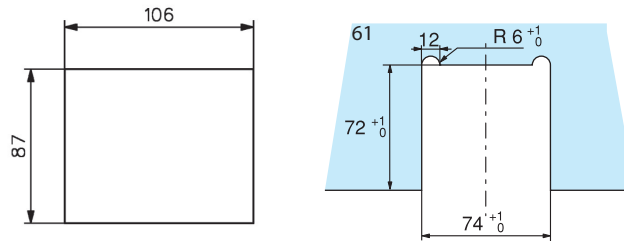

Références / References



Boîtier gâche pour serrures 1352, 1353, 1357 et 1358
Matching patch keep for lock 1352, 1353, 1357 and 1358



Laiton poli
Polished brass



Chromé brillant
Bright chromium



Chromé mat
Matt chromium

1359.00.0

1359.30.0

1359.31.0

9954

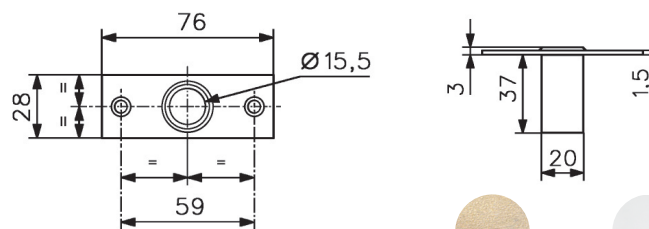

Références / References

Gâche anti-poussière à obturateur avec platine à 2 trous de fixation,
pour serrures série 1358
Keep with anti-dust guard, two fixing holes for locks series 1358



Laiton poli
Polished brass



Chromé mat
Matt chromium

9954.00.0

9954.31.0

9954.**.3

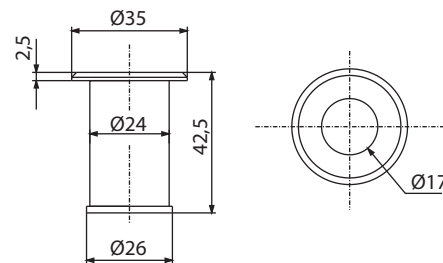

Références / References

Gâche anti-poussière à obturateur avec platine cylindrique à visser
pour serrures série 1358
Keep with anti-dust guard for locks series 1358



Laiton poli
Polished brass



Chromé mat
Matt chromium

9954.00.3

9954.31.3

Pentures,
serrures et
pièces de fixation
*Locks and
patch fittings*

Verrou cavalier à demi-cylindre 1435

Clip on lock with half euro profile cylinder 1435



Caractéristiques techniques

- Montage sans encoche
- Se pose en cavalier sur la porte, jeu minimum 4 mm
- Fixation par 2 vis de serrage pour 1435 et 1439
- Permet d'obtenir un 2ème point de condamnation avec une serrure basse série 1358
- Possibilités de combinaison avec passe général sauf 1436
- Livré avec 1 gâche plate et 3 clés

Technical features

- No notches required
- Fixing on edge of door, minimum space 4 mm
- Fixing with 2 screws for series 1435 and 1439
- To match bottom lock series 1358 to provide 2 locking points
- Possibility of combinations with master key except 1436
- Supplied with flat keep and 3 keys

1435

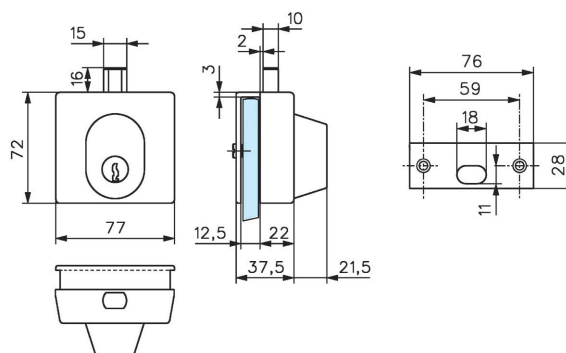

Références / References



Chromé brillant
Bright chromium



Chromé mat
Matt chromium



Doré
Gold plated

Verrou cavalier à demi-cylindre profil européen panneton DIN
Clip on lock with half euro profile cylinder

1435.30.0

1435.31.0

1435.40.0

1439

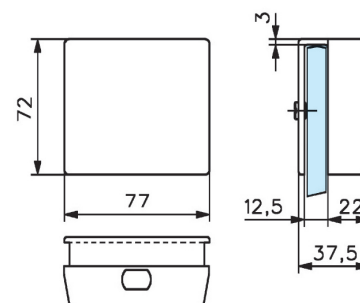

Références / References



Chromé brillant
Bright chromium



Chromé mat
Matt chromium



Doré
Gold plated

Boîtier gâche pour verrou cavalier 1435
Matching patch keep to fit with series 1435

1439.30.0

1439.31.0

1439.40.0



Pentures,
serrures et
pièces de fixation
*Locks and
patch fittings*

S171..3**



Laiton poli
Polished brass



Inox Brossé
Brushed stainless steel



Inox poli
Polished stainless steel

100 vis pour pentures séries 3272 et 3273
100 screws for patch hinge series 3272 and 3273

S171.00.3

S171.15.3

S171.16.3

S229.99.4



100 joints épaisseur 1mm pour pentures séries 3272 et 3273
100 spacers 1 mm thickness for patch hinge series 3272 and 3273

S229.99.6



100 joints épaisseur 1,5 mm pour pentures séries 3271 et 3275
100 spacers 1,5 mm thickness for patch hinge series 3271 and 3275





Pentures,
serrures et
pièces de fixation
*Patch fittings
and locks*

PF Patch fittings



Caractéristiques techniques

- Pour verre épaisseur 10 et 12 mm
- Poids maximum 80 kg
- Dimensions maxi. des portes 1100 x 2400 mm

Technical features

- For 10 and 12 mm thick glass
- Maximum Door Weight 80 kg
- Maximum Door Width 1100 x 2400 mm

LES + PRODUITS

The + product

Grande qualité
de finition

Gamme complète

Réversibles

High quality finishes

Full range

Reversible

Installation standard

Standard installation

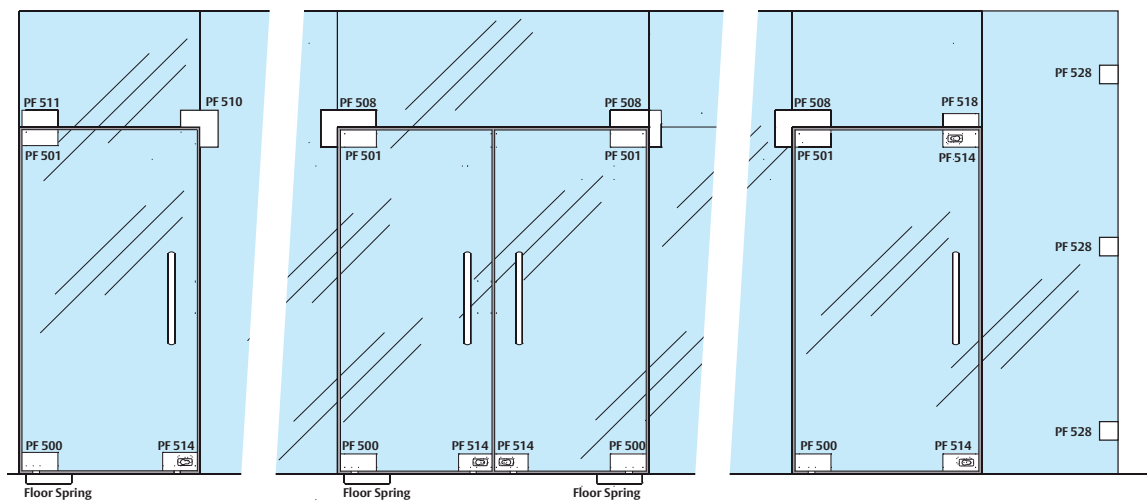
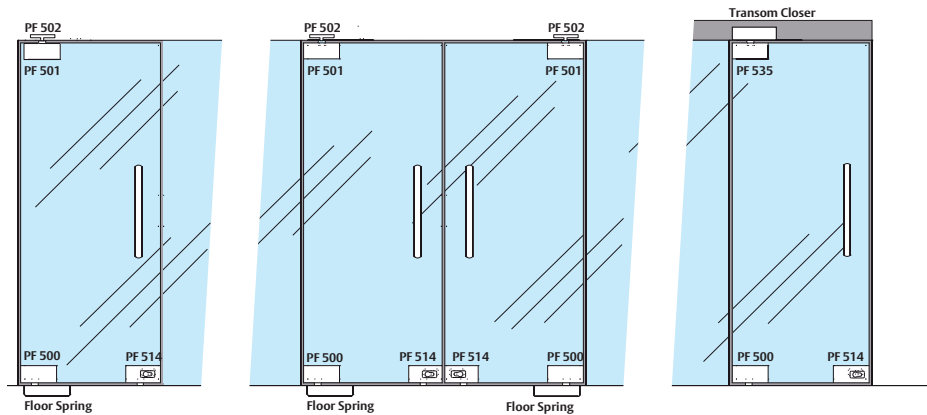



JEUX RECOMMANDÉS

RECOMMENDED TOLERANCES

Pentures,
serrures et
pièces de fixation
*Patch fittings
and locks*

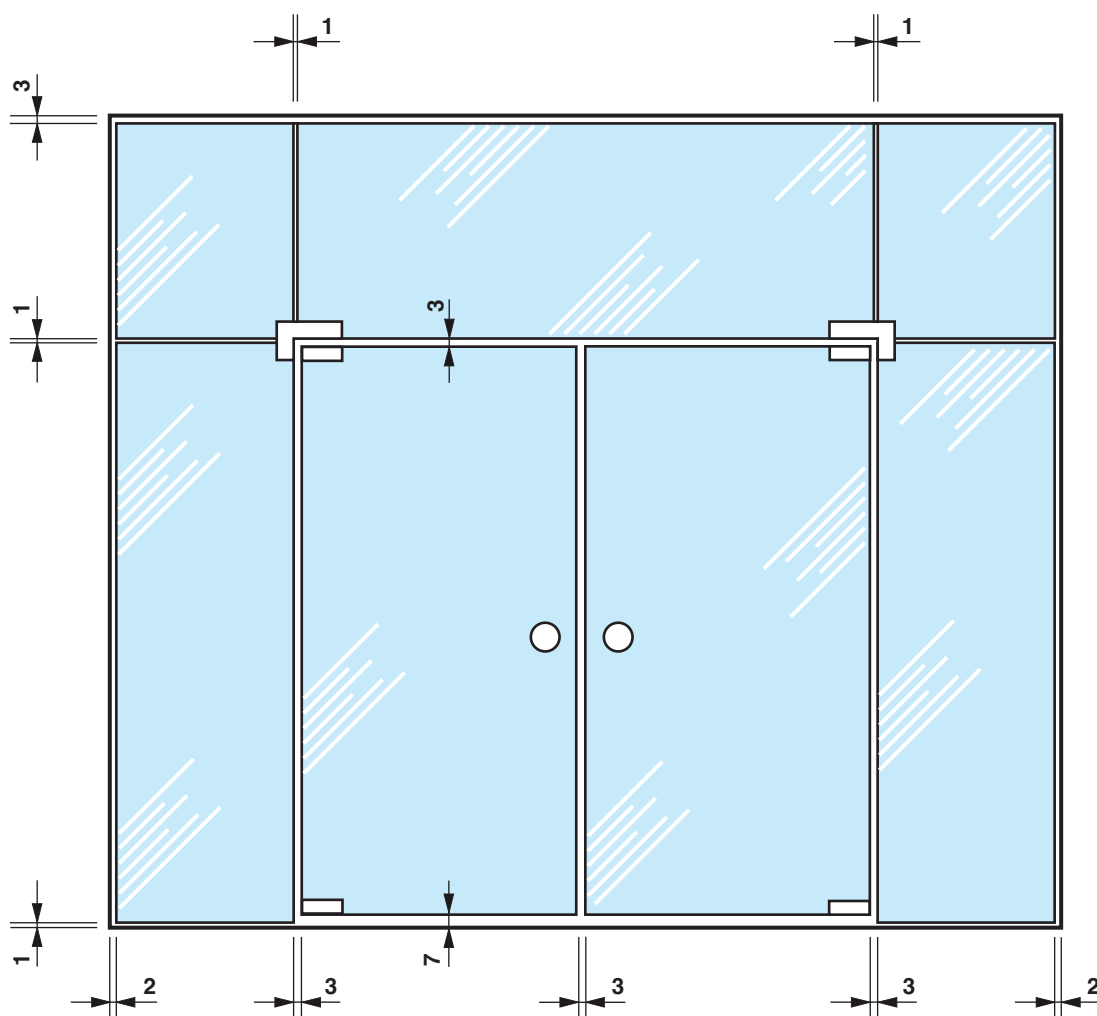



Pentures,
serrures et
pièces de fixation
*Patch fittings
and locks*

PF500

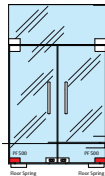
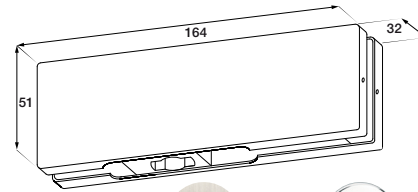
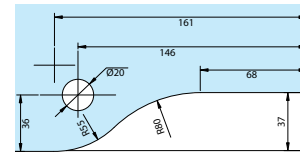

Références / References



Bottom Patch fitting for German Spindle
Bottom Patch fitting for German Spindle

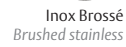

Inox Brossé
Brushed stainless steel



Inox poli
Polished stainless steel

PF500.15

PF500.16



LES + PRODUITS

The + product

Grande qualité
de finition
Gamme complète
Réversibles

*High quality finishes
Full range
Reversible*

PF501

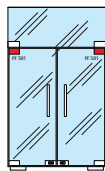
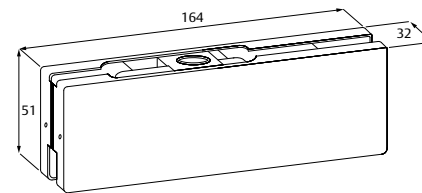
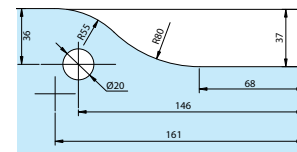

Références / References

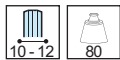

Top Patch fitting to suit 15 mm pivot.
Top Patch fitting to suit 15 mm pivot.

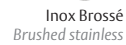

Inox Brossé
Brushed stainless steel



Inox poli
Polished stainless steel

PF501.15

PF501.16

PF535

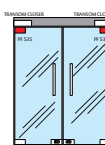
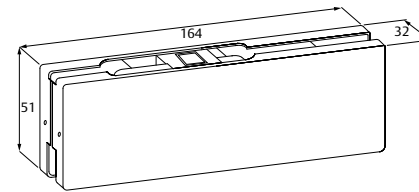
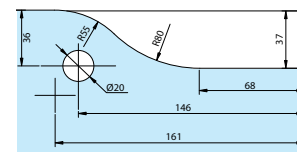
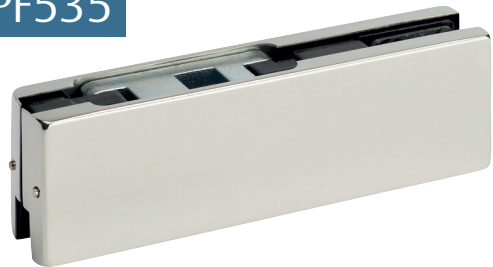

Références / References



Top Patch fitting for Transom Closer (side load).
Top Patch fitting for Transom Closer (side load).

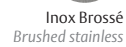

Inox Brossé
Brushed stainless steel



Inox poli
Polished stainless steel

PF535.15

PF535.16



PF502



Pentures,
serrures et
pièces de fixation
*Patch fittings
and locks*

Références / References

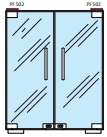

Top pivot 15 mm
Top pivot 15 mm



Inox Brossé
Brushed stainless steel

PF502 .15

AC299.33

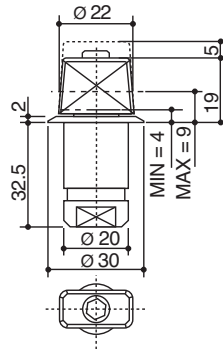

Références / References

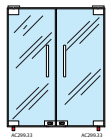

Adjustable German rectangular free swing floor pivot
Adjustable German rectangular free swing floor pivot



Pentures,
serrures et
pièces de fixation
*Patch fittings
and locks*



LES + PRODUITS
The + product

Grande qualité
de finition
Gamme complète
Réversibles

*High quality finishes
Full range
Reversible*

PF511

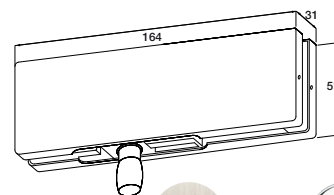
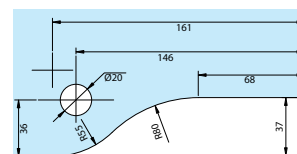

Inox Brossé
Brushed stainless steel



Inox poli
Polished stainless steel

PF511.15

PF511.16

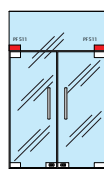

Références / References



Top Patch with 15 mm pivot
Top Patch with 15 mm pivot

PF508

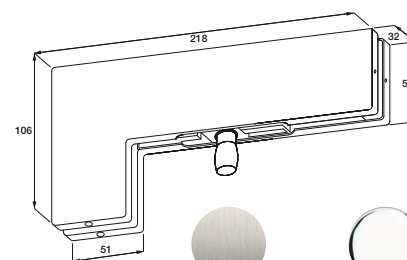
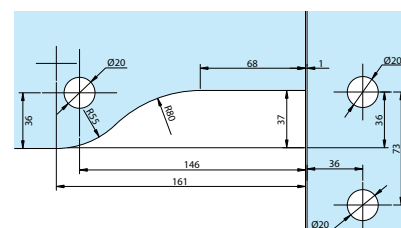

Inox Brossé
Brushed stainless steel



Inox poli
Polished stainless steel

PF508.15

PF508.16

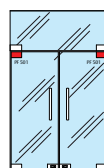

Références / References



Transom and side panel link patch
Transom and side panel link patch

PF510

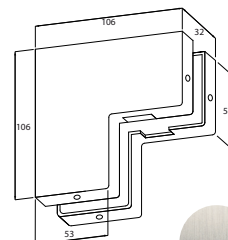
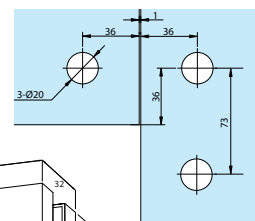

Inox Brossé
Brushed stainless steel



Inox poli
Polished stainless steel

PF510.15

PF510.16

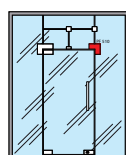

Références / References



Transom and side panel link patch
Transom and side panel link patch



Pentures,
serrures et
pièces de fixation
*Patch fittings
and locks*

PF514

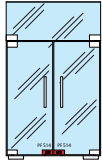
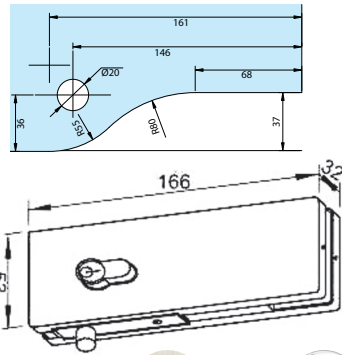

Références / References



Corner Lock for Europrofile Cylinder
Corner Lock for Europrofile Cylinder

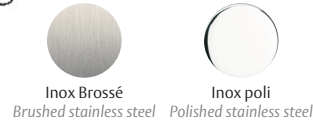

PF514.15 **PF514.16**

PF518

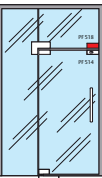
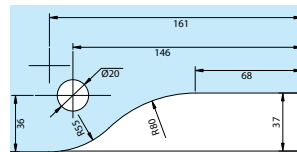

Références / References

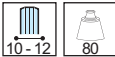

Single over panel strike box. Suits PF514.**
Single over panel strike box. Suits PF514.**



PF518.15 **PF518.16**

PF528

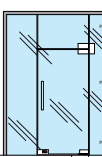
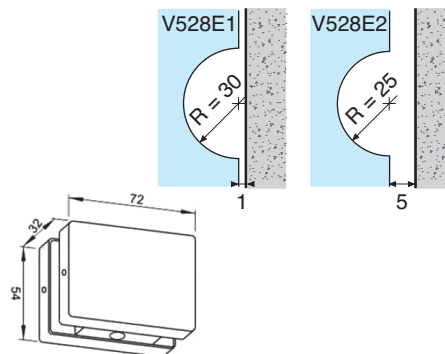

Références / References



Wall to glass patch for fixed panels
Wall to glass patch for fixed panels



PF528.15 **PF528.16**



Pentures,
serrures et
pièces de fixation
*Locks and
patch fittings*

Elite



Caractéristiques techniques

- Dimensions 52x165 mm (pièces standard V500, V501, V511, V514)
- Pour verre de 8, 10 et 12 mm
- Montage sur encoche V500E (pièces standard V500, V501, V511, V514)
- Poids maximum 100 kg
- Dimensions maxi. des portes 1250 x 2350 mm ou 1000 x 2450 mm

Pour verre épaisseur 8 et 12 mm :
Commander des intercalaires complémentaires.

Technical features

- Dimensions 52x165 mm (standard fittings V500, V501, V511, V514)
- For 8, 10 and 12mm thick glass
- Assembly on notch V500E (standard fittings V500, V501, V511, V514)
- Maximum door weight 100 kg
- Maximum size for glass doors 1250 x 2350 mm or 1000 x 2450 mm

For 8 and 12 mm thick glass :
Please order additional spacers

LES + PRODUITS

The + product

Grande qualité
de finition

Gamme complète

Réversibles

High quality finishes

Full range

Reversible





INSTALLATION STANDARD

STANDARD INSTALLATION

Pentures, serrures et pièces de fixation
Locks and patch fittings

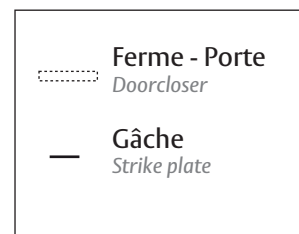
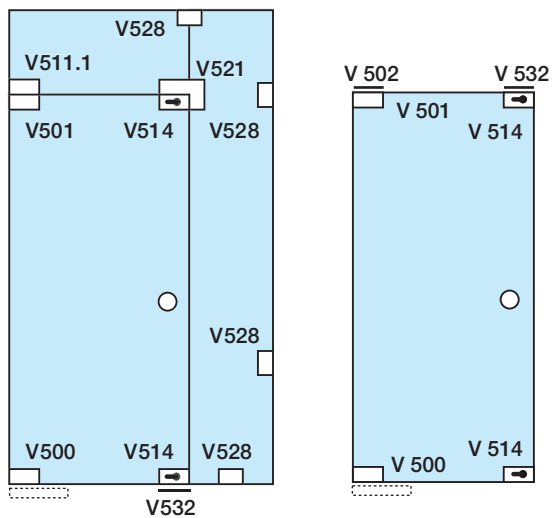
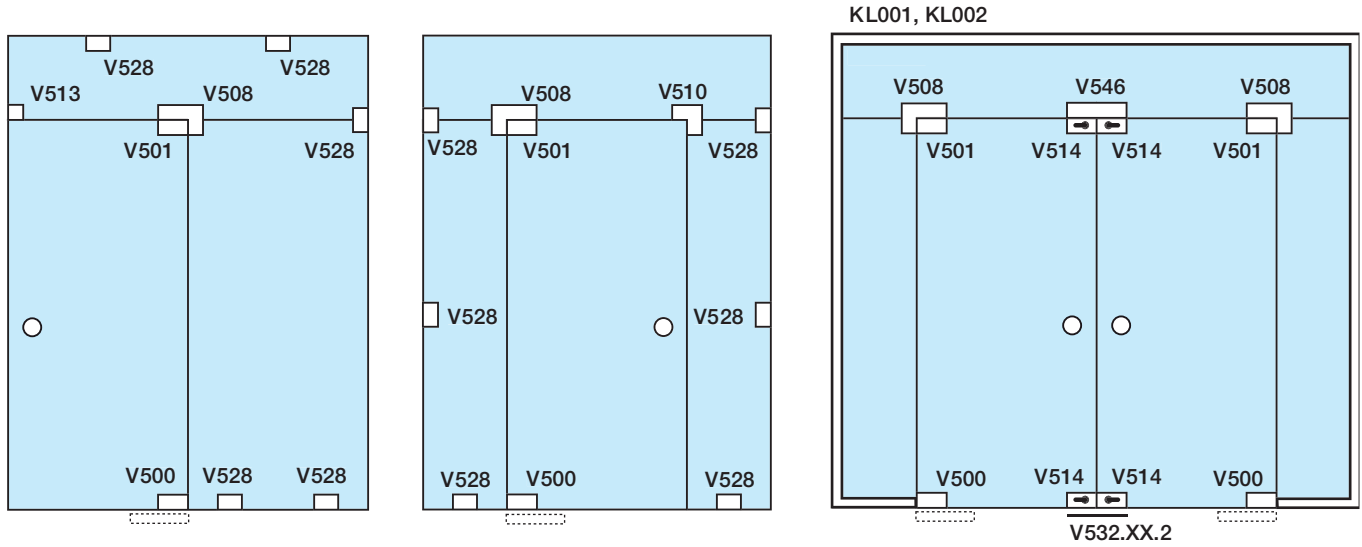
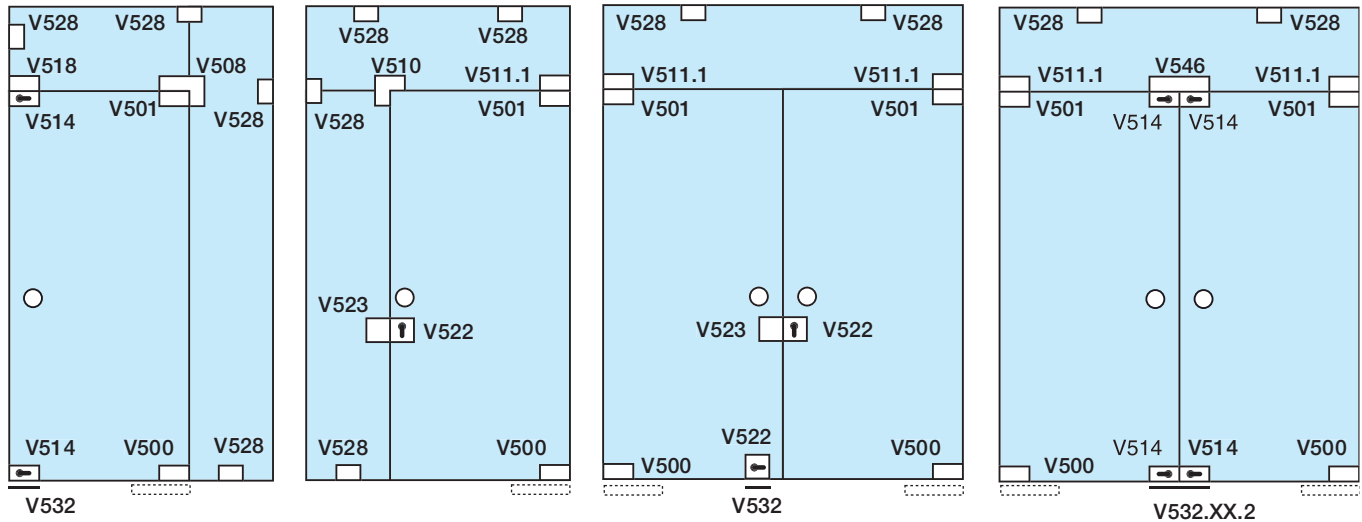



Pentures,
serrures et
pièces de fixation
*Locks and
patch fittings*

JEUX RECOMMANDÉS

RECOMMENDED TOLERANCES

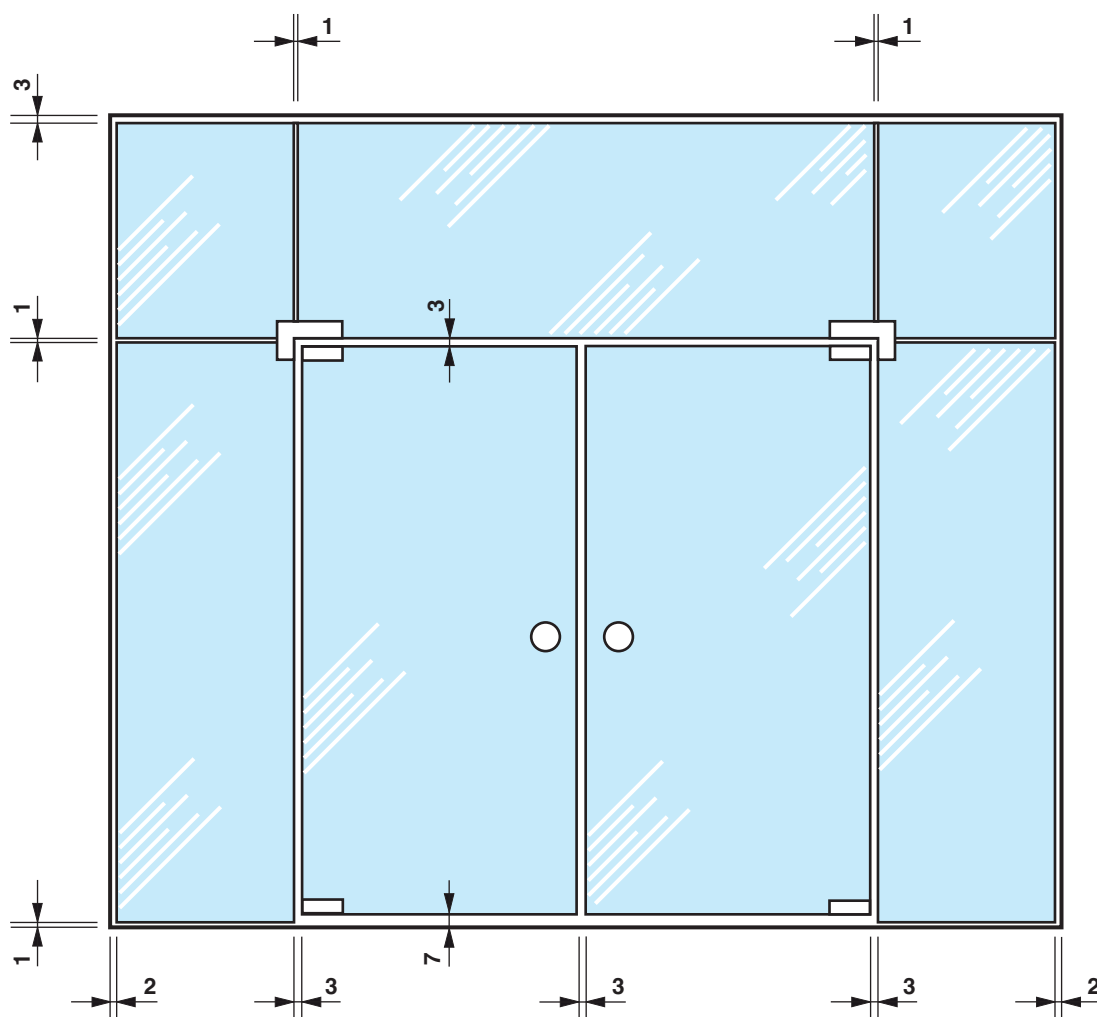

V502

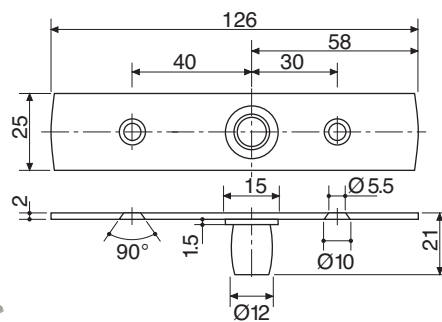

Références / References

Pivot supérieur pour V501/V201
Top pivot for V501/V201



Inox Brossé
Brushed stainless steel

V502.15



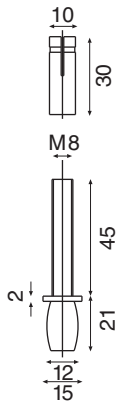

V502.3.33



Références / References



Pivot supérieur pour V501/V201
Top pivot for V501/V201

Pentures,
serrures et
pièces de fixation
*Locks and
patch fittings*

V501

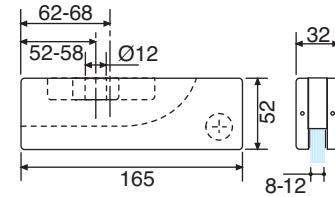
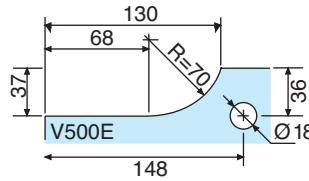
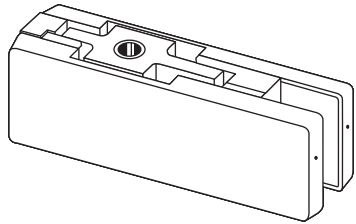

Références / References



Penture haute (Montage sur encoche V500E)
Top patch fitting (Assembly on notch V500E)

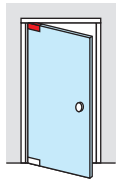

V501.01



V501.12



V501.15



V501.30

V201

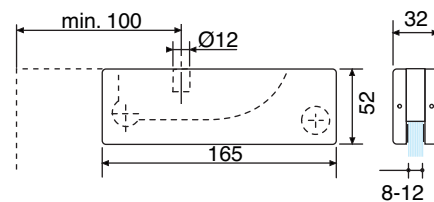
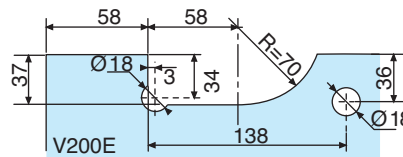
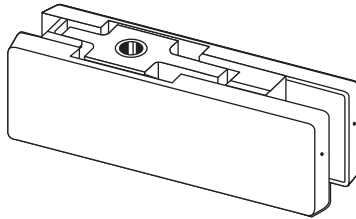

Références / References



Penture haute à rotation axiale déportée (Montage sur encoche V200E)
Top patch fitting with variable pivot point (Assembly on notch V200E)

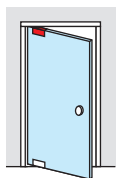

V201.12



V201.15



V201.30



Pentures,
serrures et
pièces de fixation
*Locks and
patch fittings*

V500F

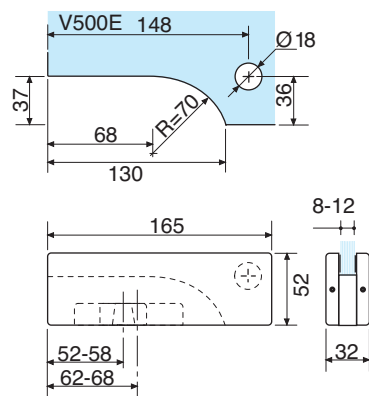
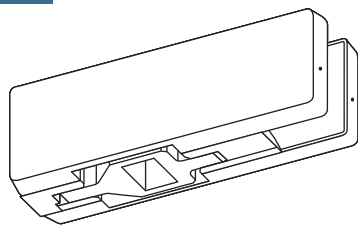

Références / References



Penture basse pour axe carré français (Montage sur encoche V500E)
Bottom patch fitting French square spindle (Assembly on notch V500E)

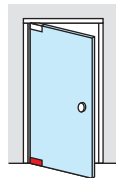

Laiton poli verni <i>Polished varnished brass</i>	Aluminium anodisé Argent Brossé <i>Brushed anodised alu. silver</i>	Inox Brossé <i>Brushed stainless steel</i>	Chromé brillant <i>Bright chromium</i>
V500F.01	V500F.12	V500F.15	V500F.30



V500D

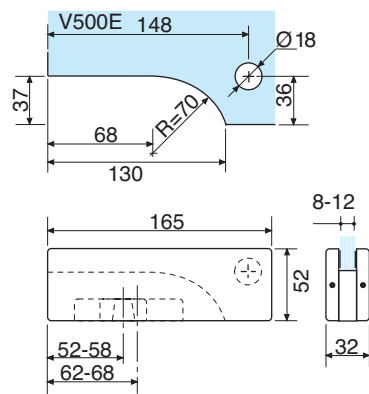
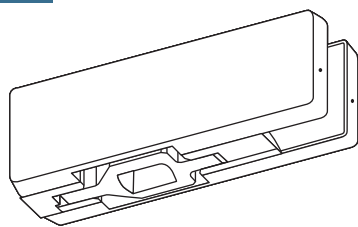

Références / References



Penture basse pour axe rectangulaire allemand (Montage sur encoche V500E)
Bottom patch fitting German rectangular spindle (Assembly on notch V500E)

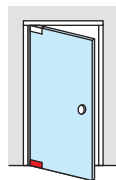

Laiton poli verni <i>Polished varnished brass</i>	Aluminium anodisé Argent Brossé <i>Brushed anodised alu. silver</i>	Inox Brossé <i>Brushed stainless steel</i>	Chromé brillant <i>Bright chromium</i>
V500D.01	V500D.12	V500D.15	V500D.30

V200D

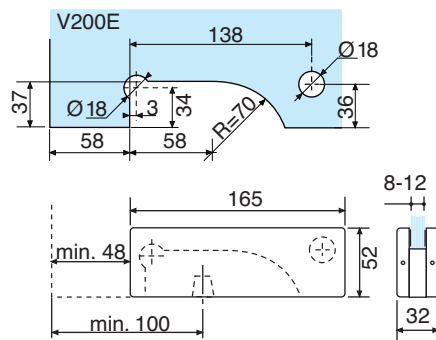
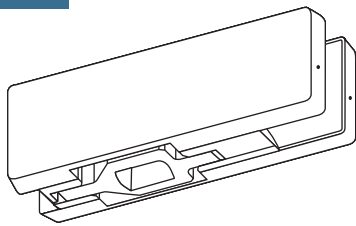

Références / References



Penture basse pour axe rectangulaire allemand à rotation axiale déportée (Montage sur encoche V200E)
Bottom patch fitting German rectangular spindle with variable pivot point (Assembly on notch V200E)

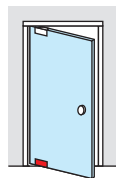

Laiton poli verni <i>Polished varnished brass</i>	Aluminium anodisé Argent Brossé <i>Brushed anodised alu. silver</i>	Inox Brossé <i>Brushed stainless steel</i>	Chromé brillant <i>Bright chromium</i>
V200D.01	V200D.12	V200D.15	V200D.30

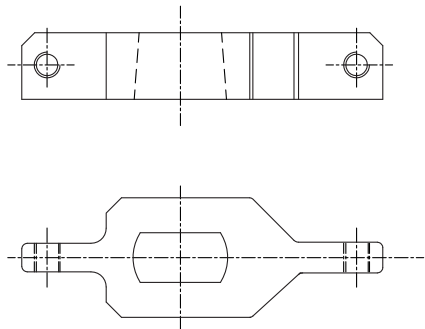

V550D

Références / References
D

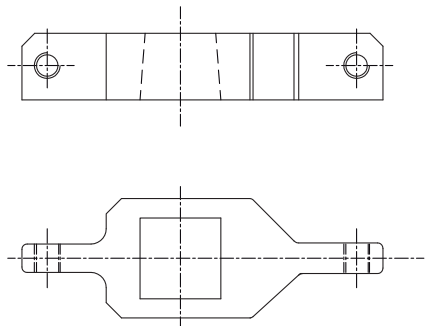
Insert rectangulaire allemand pour V500 et V200
German rectangular insert for V500 and V200

Pentures,
 serrures et
 pièces de fixation
*Locks and
 patch fittings*

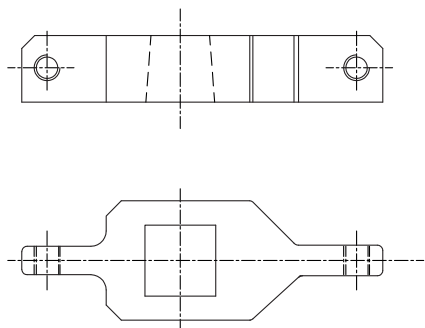
V550F

Références / References
F

Insert carré français pour V500 et V200
French square spindle for V500 and V200

V550I

Références / References
I

Insert carré italien pour V500 et V200
Italian square spindle for V500 and V200

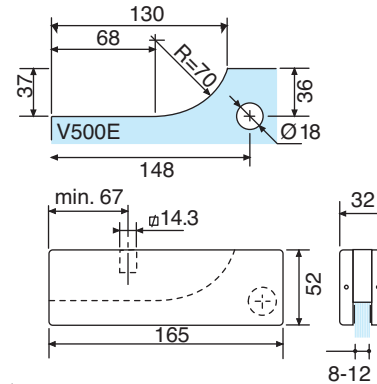
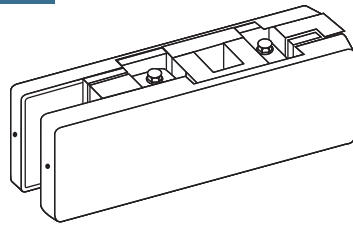

Pentures, serrures et pièces de fixation
Locks and patch fittings

V535



Références / References



Penture haute pour ferme porte 5600 (Montage sur encoche V500E)
Top patch fitting for door closer 5600 (Assembly on notch V500E)

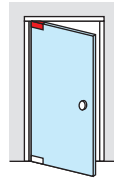

Laiton poli verni Polished varnished brass	Aluminium anodisé Argent Brossé Brushed anodised alu. silver	Inox Brossé Brushed stainless steel	Chromé brillant Bright chromium
V535.01	V535.12	V535.15	V535.30



V235

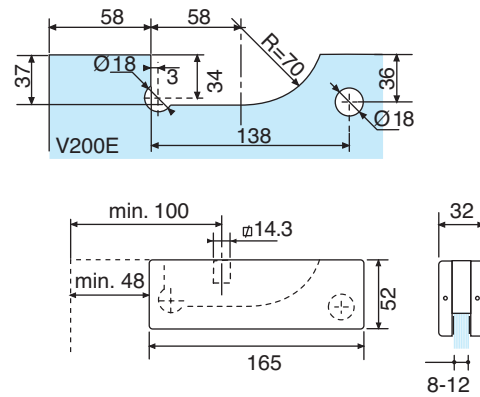
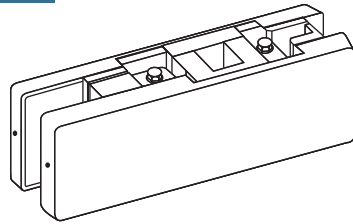

Références / References



Penture haute pour ferme porte 5600 rotation axiale déportée (Montage sur encoche V200E)
Top patch fitting for door closer 5600 with variable pivot point (To fit notch V200E)

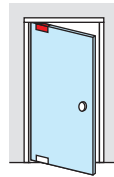

Laiton poli verni Polished varnished brass	Aluminium anodisé Argent Brossé Brushed anodised alu. silver	Inox Brossé Brushed stainless steel	Chromé brillant Bright chromium
V235.01	V235.12	V235.15	V235.30

V536

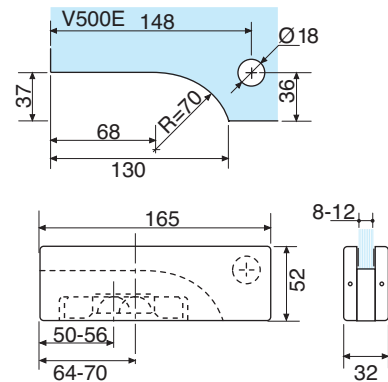
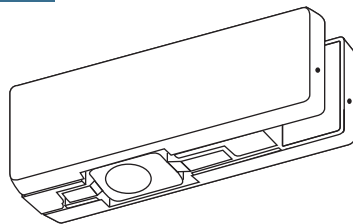

Références / References



Penture basse avec insert dome pour AC311 (Montage sur encoche V500E)
Bottom patch fitting with dome insert for AC311 (Assembly on notch V500E)

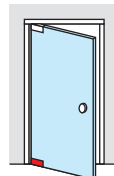

Laiton poli verni Polished varnished brass	Aluminium anodisé Argent Brossé Brushed anodised alu. silver	Inox Brossé Brushed stainless steel	Chromé brillant Bright chromium
V536.01	V536.12	V536.15	V536.30

V236

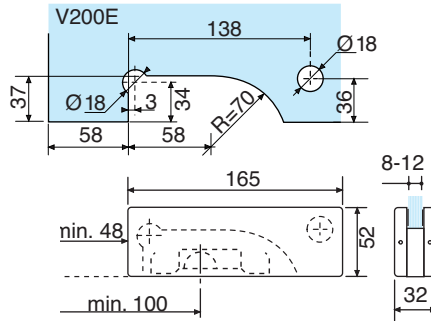
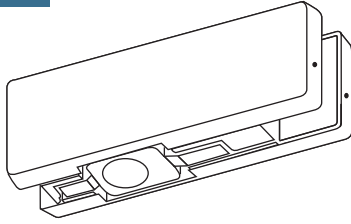

Références / References



Penture basse avec insert dome pour AC311 rotation axiale déportée (Montage sur encoche V200E)
 Bottom patch fitting with dome insert for AC311 with variable pivot point (Assembly on notch V200E)

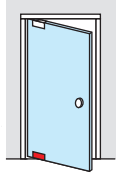

Laiton poli verni Polished varnished brass	Aluminium anodisé Argent Brossé Brushed anodised alu. silver	Inox Brossé Brushed stainless steel	Chromé brillant Bright chromium
V236.01	V236.12	V236.15	V236.30

AC311.15

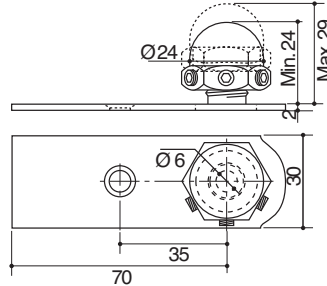

Faux pivot dome réglable pour V536
 Dome floor pivot for V536

AC246.33

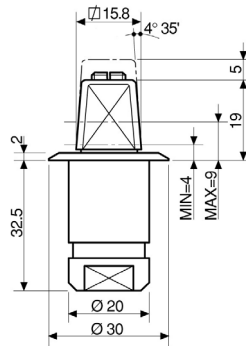

Crapaudine à sceller axe carré italien
 Adjustable Italian square free swing floor pivot

AC299.33

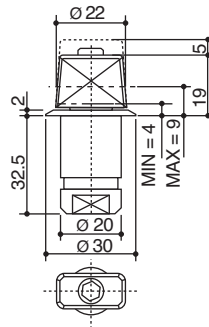

Crapaudine à sceller axe rectangulaire allemand
 Adjustable German rectangular free swing floor pivot

Pentures,
 serrures et
 pièces de fixation
*Locks and
 patch fittings*

Pentures,
serrures et
pièces de fixation
*Patch fittings
and locks*

V511.1

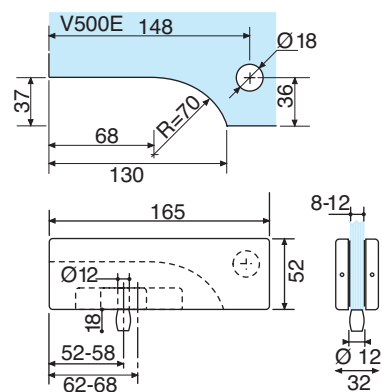
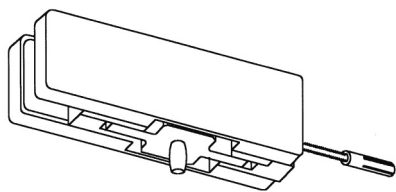

Références / References



Contre-sabot d'imposte avec tige filetée et cheville (Montage sur encoche V500E)

Side fixed transom panel patch with pivot for double acting doors with rod and plug (Assembly on notch V500E)

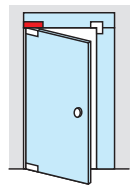

Laiton poli verni Polished varnished brass	Aluminium anodisé Argent Brossé Brushed anodised alu. silver	Inox Brossé Brushed stainless steel	Chromé brillant Bright chromium
V511.1.01	V511.1.12	V511.1.15	V511.1.30



V211

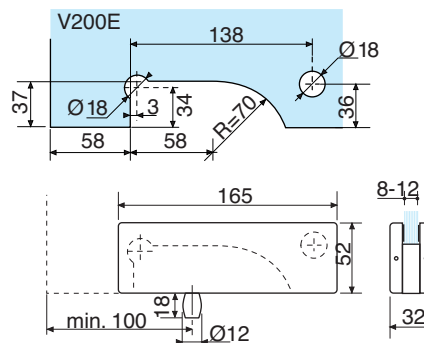
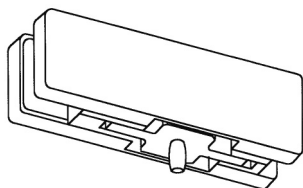

Références / References



Contre-sabot d'imposte à rotation axiale déplacée (Montage sur encoche V200E)

Transom panel patch with off-centre pivot (Assembly on notch V200E)

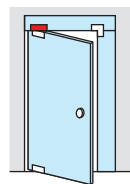

Laiton poli verni Polished varnished brass	Aluminium anodisé Argent Brossé Brushed anodised alu. silver	Inox Brossé Brushed stainless steel	Chromé brillant Bright chromium
V211.01	V211.12	V211.15	V211.30

V513

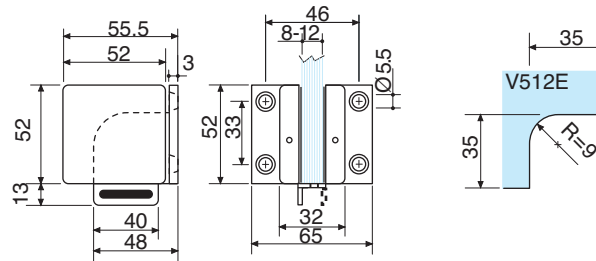
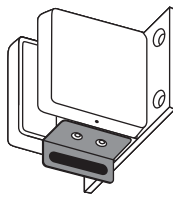

Références / References

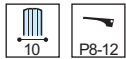

Pièce d'angle d'imposte avec plaque murale et avec butée réversible amovible (Montage sur encoche V512E)
Side fixed transom panel patch with wall plate and removable reversible stop (Assembly on notch V512E)

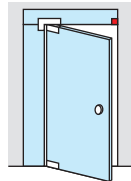

Laiton poli verni Polished varnished brass	Aluminium anodisé Argent Brossé Brushed anodised alu. silver	Inox Brossé Brushed stainless steel	Chromé brillant Bright chromium
V513.01	V513.12	V513.15	V513.30

V582

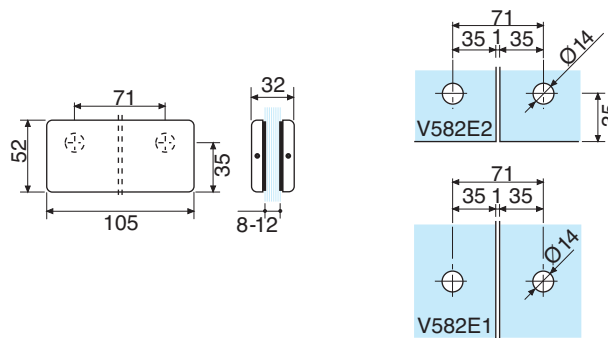
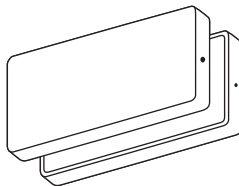

Références / References

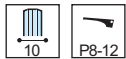

Liaison pour 2 panneaux fixes (Montage sur encoche V582E1-V582E2)
Fixed panel connector for 2 fixed panels (Assembly on notch V582E1-V582E2)

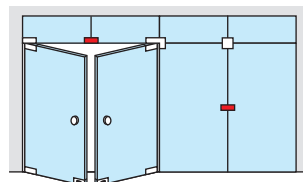

Laiton poli verni Polished varnished brass	Aluminium anodisé Argent Brossé Brushed anodised alu. silver	Inox Brossé Brushed stainless steel	Chromé brillant Bright chromium
V582.01	V582.12	V582.15	V582.30

V528

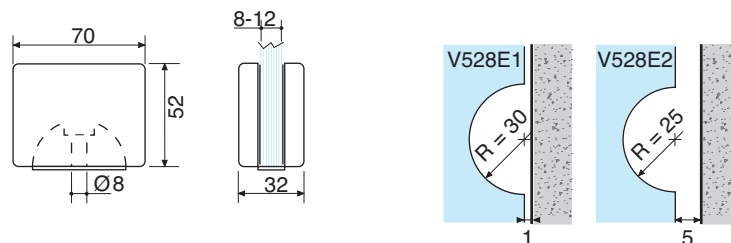
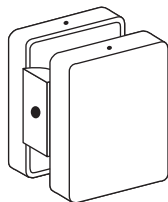

Références / References

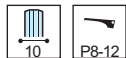

Pièce de fixation murale pour glaces fixes à vis (Montage sur encoche V528E1-V528E2)
Wall to glass patch for fixed panel to screw on (Assembly on notch V528E1-V528E2)

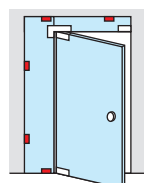

Laiton poli verni Polished varnished brass	Aluminium anodisé Argent Brossé Brushed anodised alu. silver	Inox Brossé Brushed stainless steel	Chromé brillant Bright chromium
V528.01	V528.12	V528.15	V528.30

Pentures,
serrures et
pièces de fixation
*Locks and
patch fittings*

V581

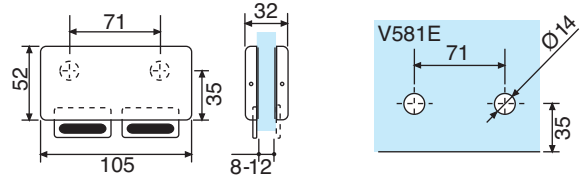
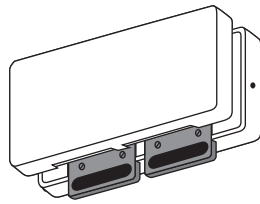

Références / References

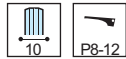

Pièce de liaison pour 2 glaces fixes avec double butée réversible (Montage sur encoche V581E)
Fixed panel connector for two fixed panels with reversible stop (Assembly on notch V581E)

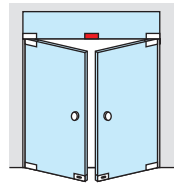

Laiton poli verni <i>Polished varnished brass</i>	Aluminium anodisé Argent Brossé <i>Brushed anodised alu. silver</i>	Inox Brossé <i>Brushed stainless steel</i>	Chromé brillant <i>Bright chromium</i>
V581.01	V581.12	V581.15	V581.30

V514

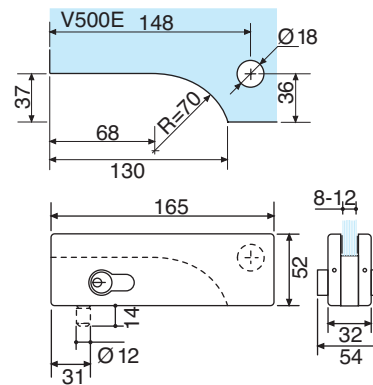
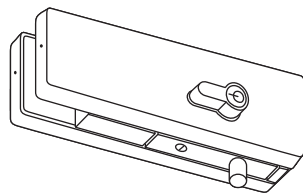

Références / References

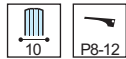

Serrure d'angle avec cylindre Européen (Montage sur encoche V500E)
Corner lock with Euro profile cylinder (Assembly on notch V500E)

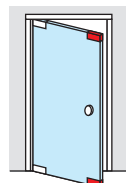

Laiton poli verni <i>Polished varnished brass</i>	Aluminium anodisé Argent Brossé <i>Brushed anodised alu. silver</i>	Inox Brossé <i>Brushed stainless steel</i>	Chromé brillant <i>Bright chromium</i>
V514.01	V514.12	V514.15	V514.30

V519.1

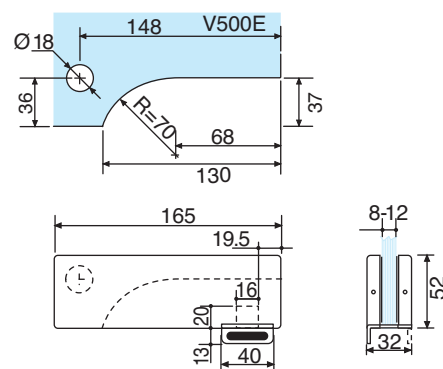
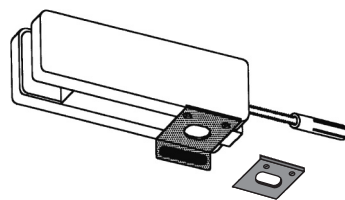

Références / References

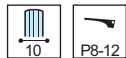

Contre-boîtier pour serrure de coin avec ou sans butée réversible et tige filetée (Montage sur encoche V500E)
Side fixed transom panel patch for corner lock with or without reversible stop, rod and plug (Assembly on notch V500E)

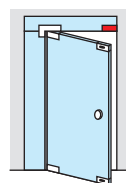

Laiton poli verni <i>Polished varnished brass</i>	Aluminium anodisé Argent Brossé <i>Brushed anodised alu. silver</i>	Inox Brossé <i>Brushed stainless steel</i>	Chromé brillant <i>Bright chromium</i>
V519.1.01	V519.1.12	V519.1.15	V519.1.30

V546

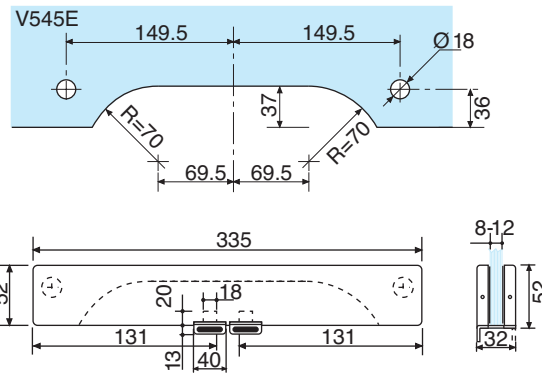
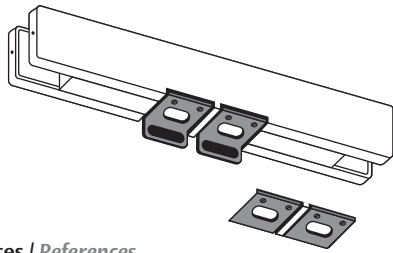

Références / References



Double contre-boîtier pour serrure d'angle avec ou sans butée réversible (Montage sur encoche V500E)
Double transom panel patch for corner lock with or without reversible stop (Assembly on notch V500E)

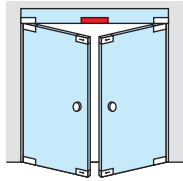

Laiton poli verni Polished varnished brass	Aluminium anodisé Argent Brossé Brushed anodised alu. silver	Inox Brossé Brushed stainless steel	Chromé brillant Bright chromium
V546.01	V546.12	V546.15	V546.30

V522

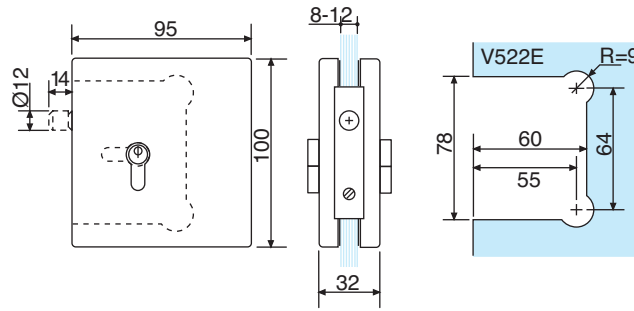
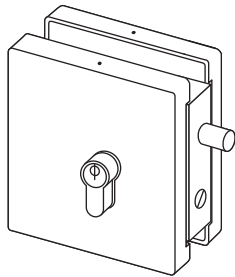

Références / References

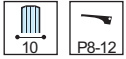

Serrure universelle à pêne dormant avec cylindre Européen (Montage sur encoche V522E)
Reversible lock with Euro profile cylinder (Assembly on notch V522E)

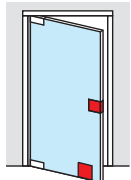

Laiton poli verni Polished varnished brass	Aluminium anodisé Argent Brossé Brushed anodised alu. silver	Inox Brossé Brushed stainless steel	Chromé brillant Bright chromium
V522.01	V522.12	V522.15	V522.30

V523

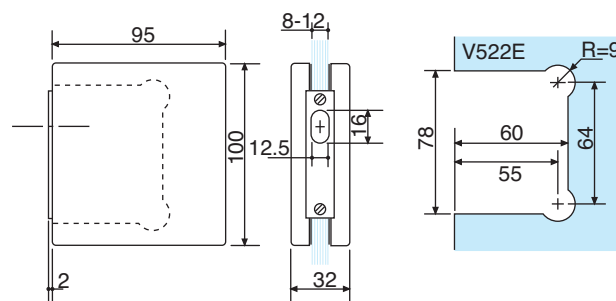
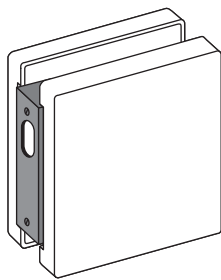

Références / References

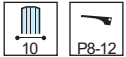

Contre-boîtier pour V522 (Montage sur encoche V522E)
Patch keep for V522 (Assembly on notch V522E)

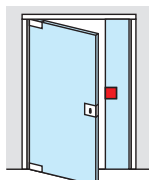

Laiton poli verni Polished varnished brass	Aluminium anodisé Argent Brossé Brushed anodised alu. silver	Inox Brossé Brushed stainless steel	Chromé brillant Bright chromium
V523.01	V523.12	V523.15	V523.30

Pentures,
serrures et
pièces de fixation
*Locks and
patch fittings*

V542.2

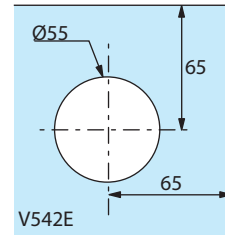
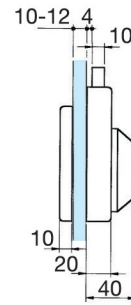
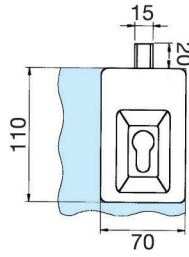
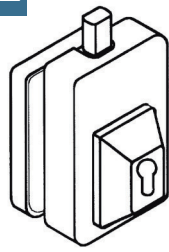

Références / References



Serrure d'angle réversible pour cylindre Européen (Montage sur encoche V542E)
Reversible corner lock with Euro profile cylinder and security rosettes (Assembly on notch V542E)

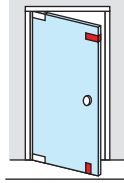

Aluminium anodisé Argent Brossé
Brushed anodised alu. silver

Inox Brossé
Brushed stainless steel

Chromé brillant
Bright chromium

V542.2.12

V542.2.15

V542.2.30



V515

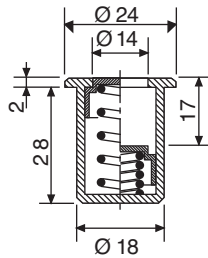

Références / References

Gâche anti-poussière pour V514 - V522
Tubular dustproof bolt keep for V514 - V522

Chromé mat brossé
Brushed matt chromium

V515.33

V532

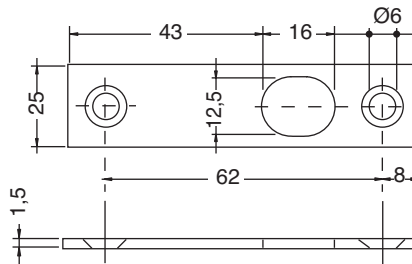

Références / References

Gâche pour V514 - V522 - V542.2 - C222
Flat keep for V514 - V522 - V542.2 - C222

Inox Brossé
Brushed stainless steel

V532.15

V532.2

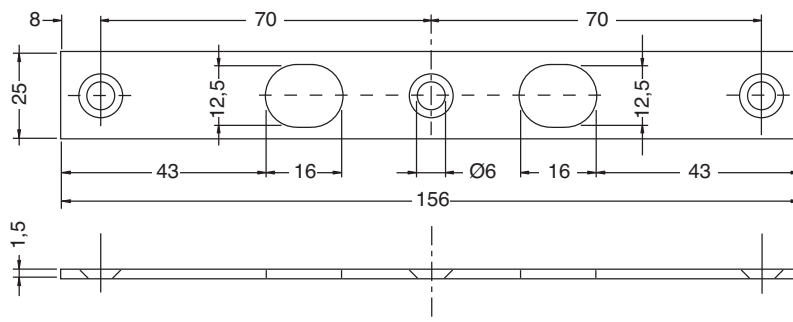

Références / References

Gâche pour 2 serrures de coin V514
Flat keep for 2 corner locks V514

Inox Brossé
Brushed stainless steel

V532.2.15



V510

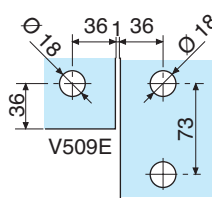
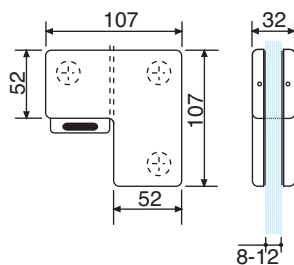
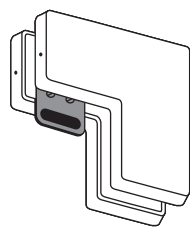

Références / References

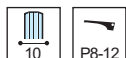

Pièce de liaison imposte et glace fixe avec butée réversible (Montage sur encoche V509E)
 Transom and side panel link patch with reversible stop (Assembly on notch V509E)

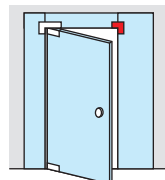

Laiton poli verni Polished varnished brass	Aluminium anodisé Argent Brossé Brushed anodised alu. silver	Inox Brossé Brushed stainless steel	Chromé brillant Bright chromium
V510.01	V510.12	V510.15	V510.30

V508

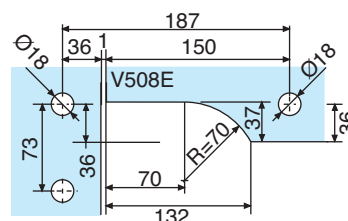
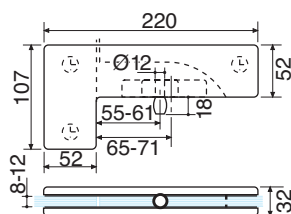
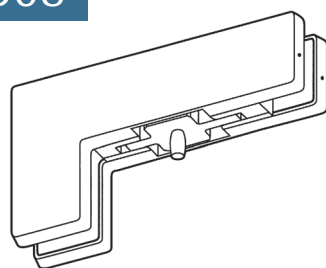

Références / References

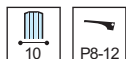

Pièce de liaison imposte et glace fixe avec pivot (Montage sur encoche V508E)
 Transom and side panel link patch with pivot (Assembly on notch V508E)

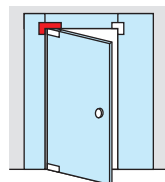

Laiton poli verni Polished varnished brass	Aluminium anodisé Argent Brossé Brushed anodised alu. silver	Inox Brossé Brushed stainless steel	Chromé brillant Bright chromium
V508.01	V508.12	V508.15	V508.30

Pentures,
serrures et
pièces de fixation
*Locks and
patch fittings*



Pentures, serrures et pièces de fixation
Locks and patch fittings

V521

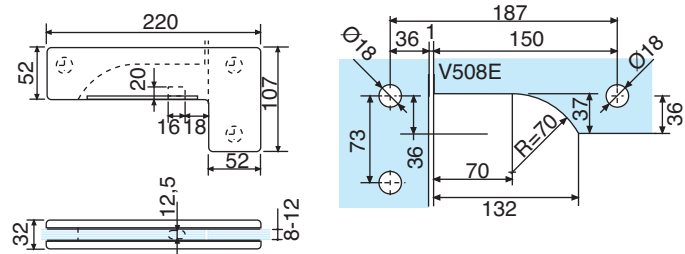
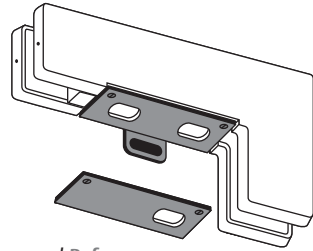

Références / References

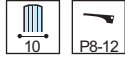

Pièce de liaison imposte et glace fixe, contre-boîtier avec ou sans butée réversible pour serrure V514 (Montage sur encoche V508E)
Transom and side panel link patch with strike with or without reversible stop for lock V514 (Assembly on notch V508E)

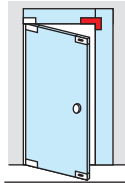

V521.01 V521.12 V521.15 V521.30



V564

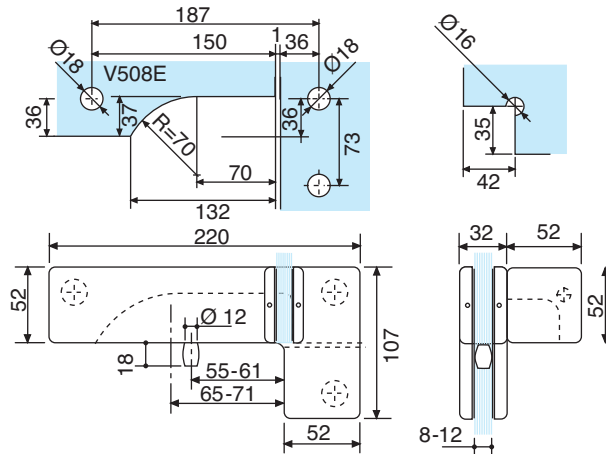
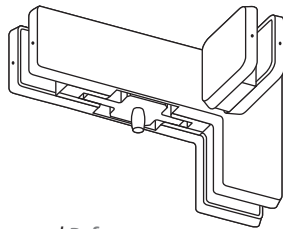

Références / References

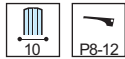

Pièce de liaison imposte et glace fixe avec pivot et ailette de contreventement (Montage sur encoche V508E + V512E1)
Transom and side panel link patch with pivot and fin link holder (Assembly on notch V508E + V512E1)

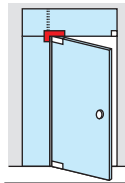

V564.12 V564.15

V565

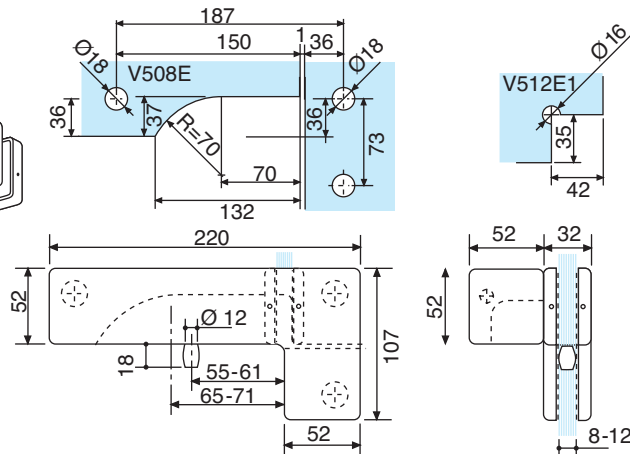
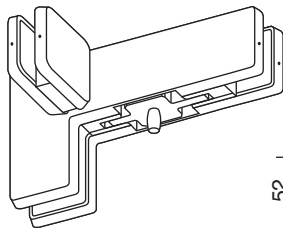

Références / References

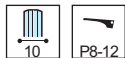

Pièce de liaison imposte et glace fixe avec pivot et ailette de contreventement (Montage sur encoche V508E + V512E)
Transom and side panel link patch with pivot and fin link holder (Assembly on notch V508E + V512E)

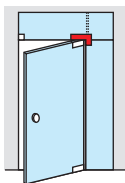

V565.12 V565.15



Serrures anti-paniques
Anti-panic locks

ASSA ABLOY

Serrures anti-paniques
Anti-panic locks



LES + PRODUITS
The + product

Adaptée pour porte en verre
Esthétique

Adapted to glass doors
Aesthetic

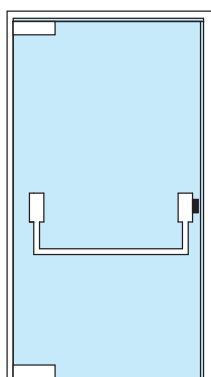

Porte A / Door A

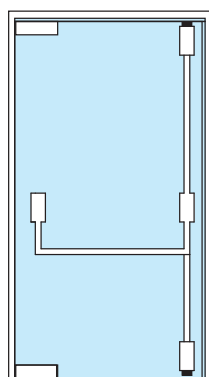

Porte B / Door B

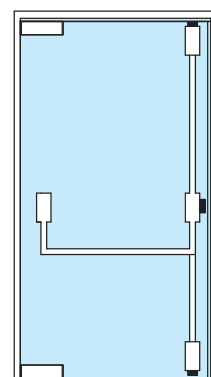

Porte C / Door C

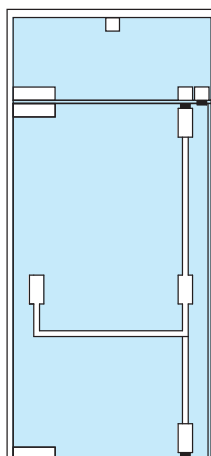

Porte D / Door D

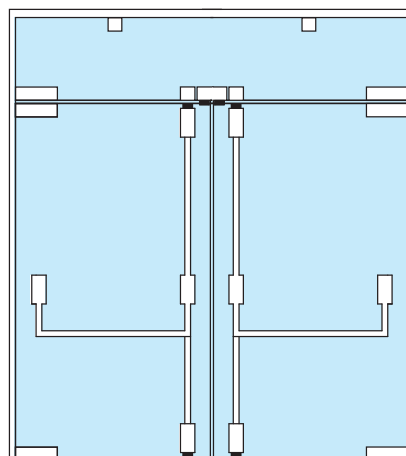

Porte E / Door E

ARTICLES NÉCESSAIRES / REFERENCES NEEDED

Type de condamnation Closing Type	M1040 + V586 Encoche N°1 Notch N°1	AO22330 + V587 Encoche N°2 Notch N°2	V588 Encoche N°6 Notch N°6	AO41730 Poignée Ext. Ext. Handle
Porte A / Door A	1			1
Porte B / Door B	1	1		1
Porte C / Door C	1	1		1
Porte D / Door D	1	1	1	1
Porte E / Door E	2	2	2	2

M1040 + V586

Serrures anti-paniques
Anti-panic locks

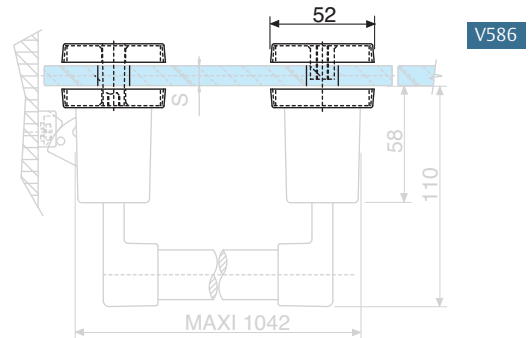
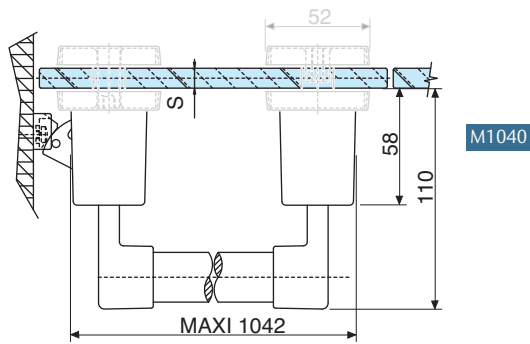
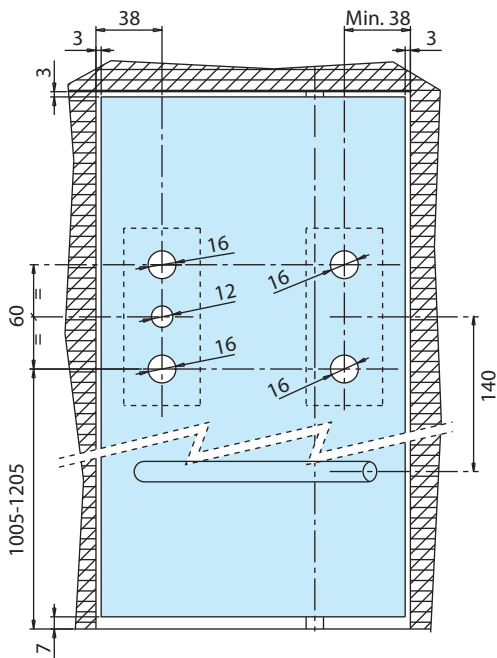

Références / References

M1040

Barre anti-panique pour sortie de secours (995 mm),
montage sur verre avec accessoire V586
Anti panic device for single glass door to fit on glass with accessory V586.

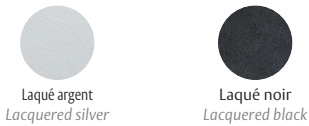

M1040.73 **M1040.52**

V586



Accessoire pour montage du mécanisme
de fermeture latérale M1040 (Montage sur encoche)
*Pair of glass fitting, for side latch mechanism for M1040 panic
exit device (Assembly on notch)*



V586.12 **V586.19**

Serrures anti-paniques
Anti-panic locks

AO22330 + V587

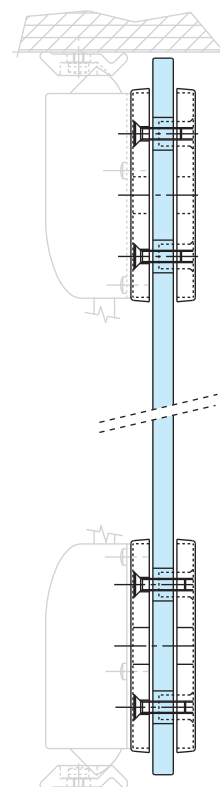
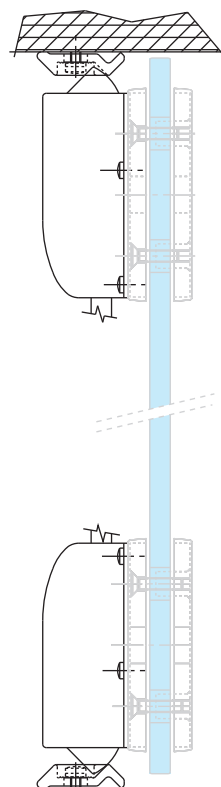
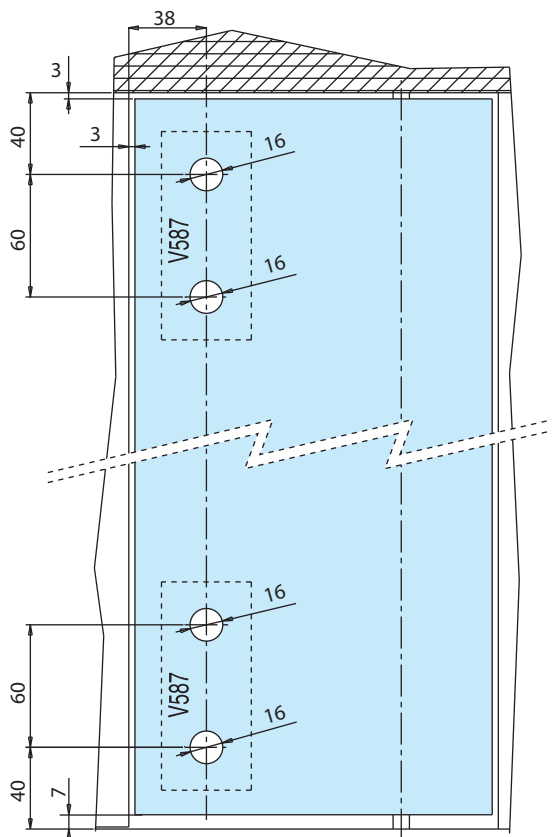

AO22330

V587

Références / References

AO22330

Mécanisme de fermeture supérieur et inférieur avec tringles et butées, pour porte jusqu'à 2500 mm, montage sur verre avec accessoire V587
Top and bottom latches, strikers and vertical rods for doors up to 2500 mm to fit on the glass with accessory V587



Laqué argent
Lacquered silver

AO22330.73



Laqué noir
Lacquered black

AO22330.52

V587



Accessoire pour montage du mécanisme supérieur et inférieur AO22330 (Montage sur encoche)
Pair of supports for top and bottom latch to fit accessory AO22330 (Assembly on notch)



Aluminium anodisé Argent Brossé
Brushed anodised alu. silver

V587.12



Aluminium anodisé noir
Black Anodised

V587.19

V588

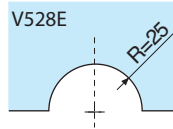
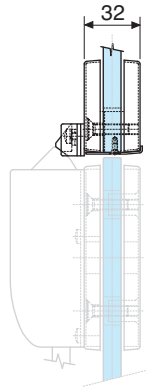

Serrures
anti-paniques
Anti-panic locks

Références / References



Boîtier gâche supérieur montage sur imposte
Matching patch keep to fit on overhead panel



V588.12 **V588.19**

AO41730

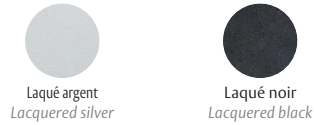
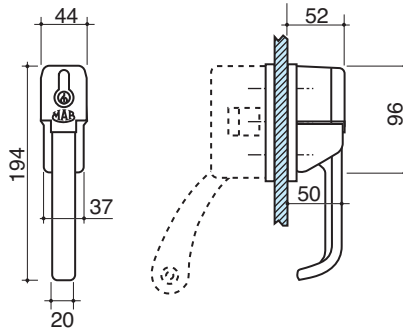

Références / References

Poignée de manoeuvre extérieure à cylindre
(manoeuvrable avec clé uniquement). Utilisation avec M1040.
Handle with locking cylinder (opening with key only).
Use with M104

AO41730.73 **AO41730.52**

