

**System: Combi-Laufschiene für Wand- oder Deckenmontage für 1 Glastüre bis 100 kg. Design Clip-Blende Alu oder Holz**

System: Combi running track for wall or ceiling mounting for 1 glass panel up to 100 kg. Design Aluminium or wood clip fascia

Système: Rail de roulement Combi pour montage mural ou au plafond pour 1 porte en verre jusqu'à 100 kg. Design Cache à clipser en alu ou en bois

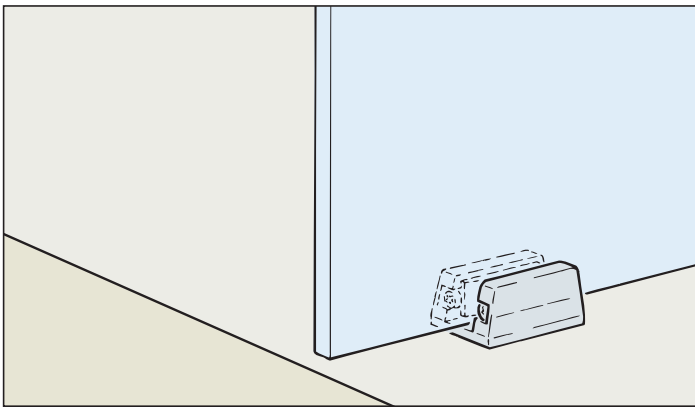

**Einbaubeispiele / Mounting examples / Exemples de montage**

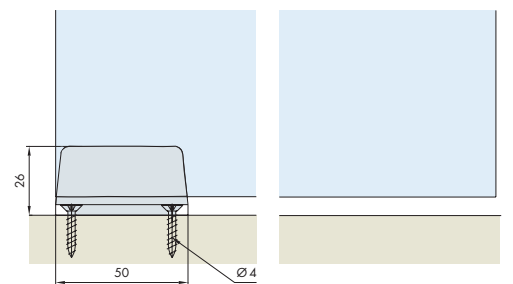
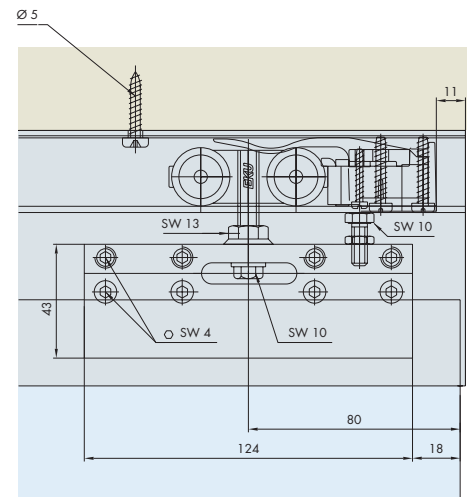
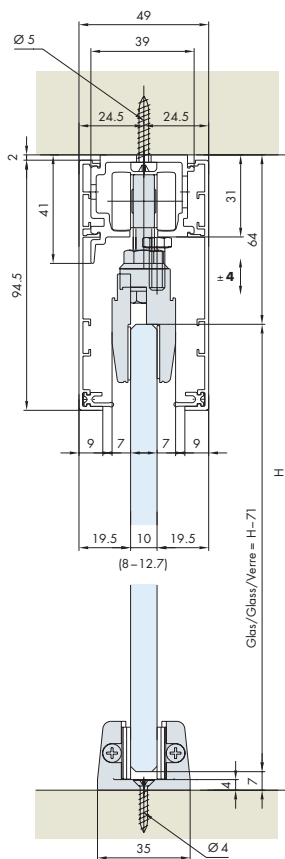
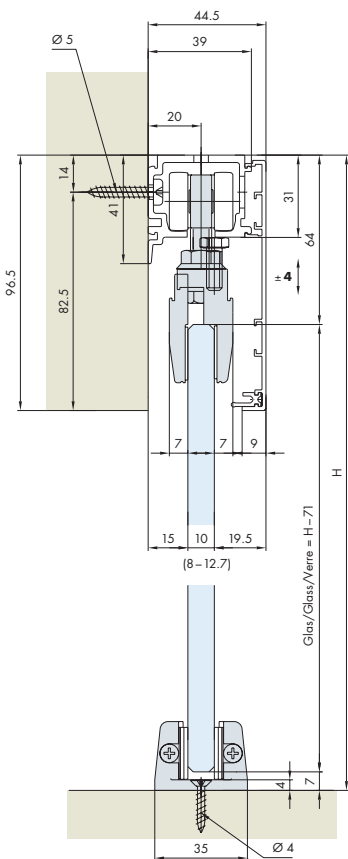

**Einbauvarianten mit Holzblende**

Mounting versions with wooden fascia / Variantes de montage avec cache en bois

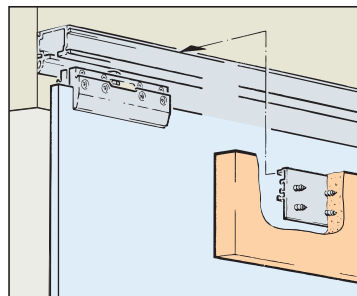
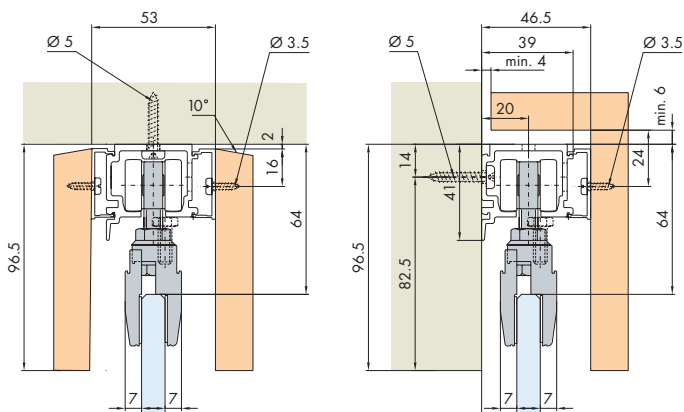

**Befestigungsabstand für Clip-Teil alle 400 bis 600 mm**

Fixing distance for clip component every 400 to 600 mm

Distance des clips tous les 400 à 600 mm

**Garnituren / Sets / Garnitures**

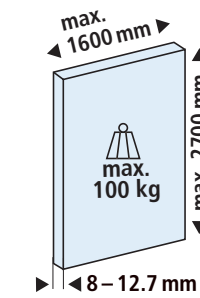

**Türgewichte**  
 Door weights  
 Poids de portes 34

<b>1</b> Türe Door Porte		<b>No. 057.3074.071</b>	
2x	2x	2x	2x
1x	1x	1x	1x
1x			1x

**Zubehör / Accessories / Accessoires**

**Combi-Laufschiene Alu, gelocht**

Combi running track aluminium, pre-drilled  
 Rail de roulement en alu, perforé

Gr./Size

Art. No.

1700 mm	057.3048.170
2000 mm	057.3048.200
2500 mm	057.3048.250
6000 mm	057.3048.600*

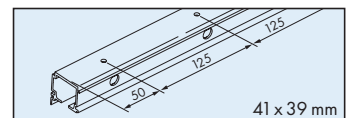

**Clip-Blende zu Laufschiene Alu, eloxiert**

Clip fascia for running track aluminium, anodized  
 Cache à clipser pour rail de roulement en alu, anodisé

2500 mm	057.3050.250
3500 mm	057.3050.350
6000 mm	057.3050.600*

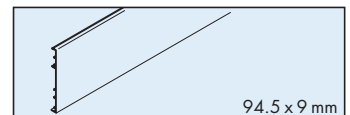

**Blendenendstück-Set Alu, eloxiert, einseitig, Wandmontage**

Fascia end component set aluminium, anodized, one-sided, wall mounting  
 Jeu d'extrémités de cache en alu, anodisé, un côté, montage mural

44.5 mm	057.3052.074
---------	--------------

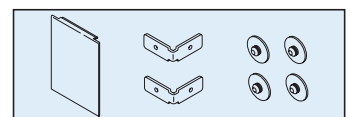

**Blendenendstück-Set Alu, eloxiert, einseitig, Deckenmontage**

Fascia end component set aluminium, anodized, one-sided, ceiling mounting  
 Jeu d'extrémités de cache en alu, anodisé, un côté, montage au plafond

49.0 mm	057.3052.071
---------	--------------

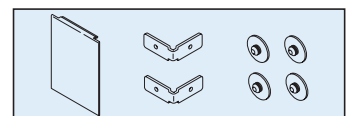

**Clip-Teil für Holzblende Alu, gelocht**

Clip component for wooden fascia aluminium, pre-drilled  
 Clip en alu pour cache en bois, perforé

1 x	057.3063.002
-----	--------------

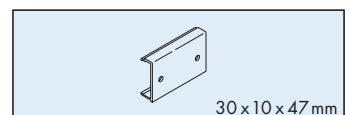

**Sichtschutzdichtung, Kunststoff schwarz, in Rollen**

Screening seal, black plastic, in rolls  
 Joint pare-vue, plastique noir, en rouleaux

20 m	057.3078.002
------	--------------

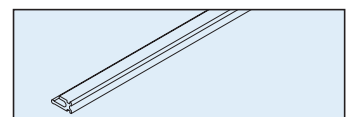

\*min. 60 m

**Sonderzubehör / Special accessories / Accessoires spéciaux:** 29-33

**Technische Daten / Technical data / Caractéristiques techniques:** 34

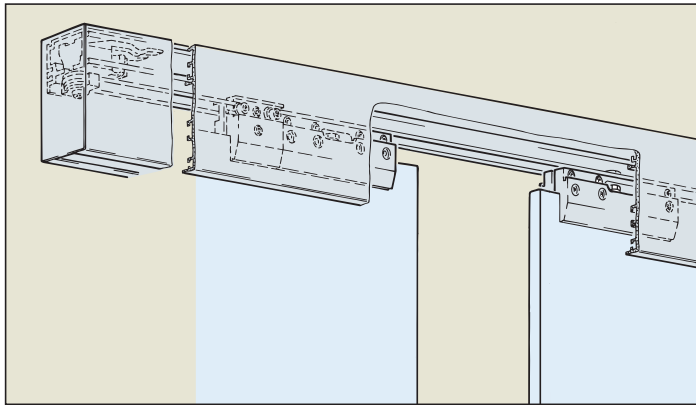

**Systemzusatz: Synchro für 2 synchronlaufende Glastüren mit Kevlarseil zu EKU PORTA G/GF/GFO**

**System addition:** Synchro for 2 synchronized running glass panels with kevlarseil for EKU PORTA G/GF/GFO

**Supplément de système:** Synchro pour 2 portes en verre synchronisées avec câble kevlarseil pour EKU PORTA G/GF/GFO

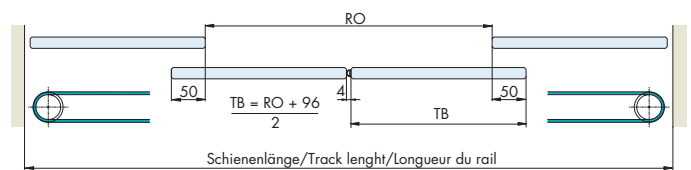
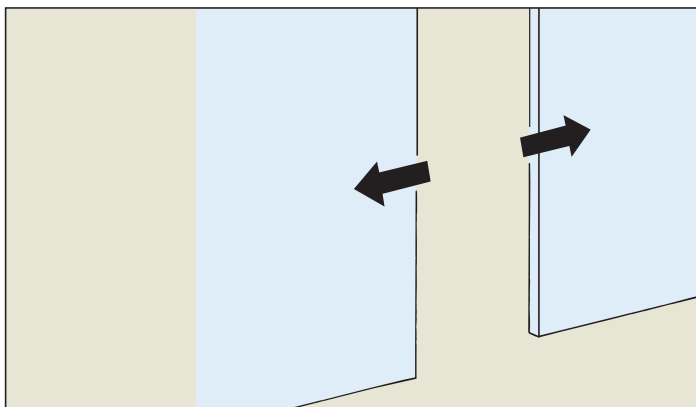

**Einbaubeispiele / Mounting examples / Exemples de montage**

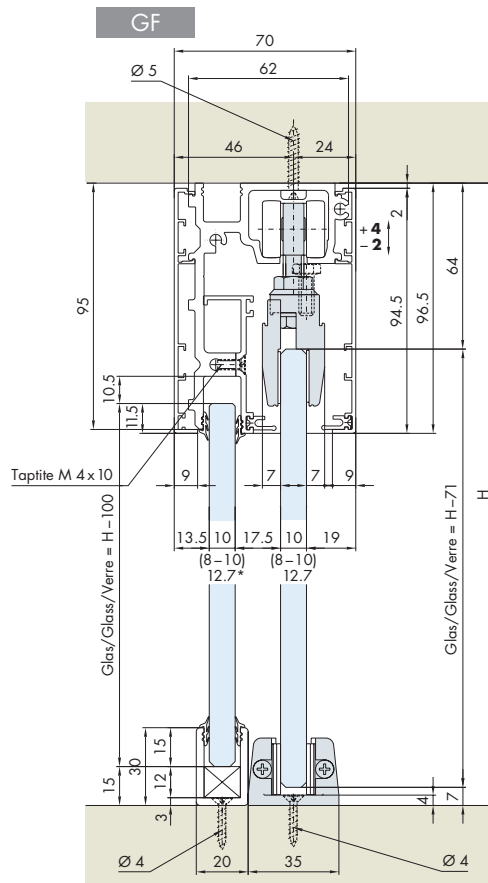
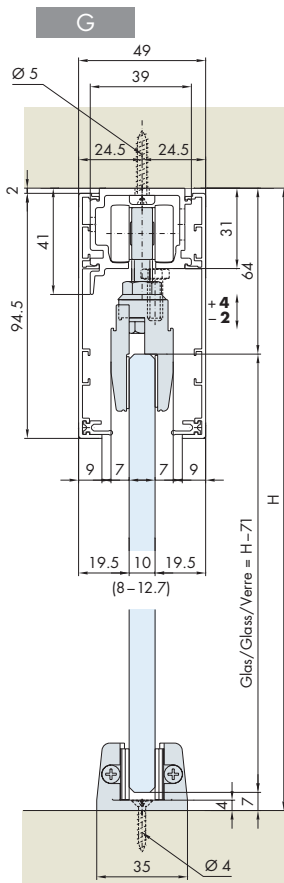

\* 12,7mm Glas, Nassversiegelung mit Silikon  
12,7mm glass, wet caulking with silicone  
12,7mm verre scellage au mouillé avec silicone  
Art. No. 098.0027.000 □ 29

